

## 14000 I/O Series Multiplane Storefront Framing

Glass or panels can be positioned to the inboard (I) or outboard (O) side of the 4-1/2" depth frame to achieve the look you imagine. Typical glass thickness is 1", and can be installed from the outside or inside of the building. Special glazing pocket reducers allow the use of 1/4" infill thicknesses, too.

14000 I/O Series Multiplane Storefront Framing thermal barrier insulates exterior surfaces from the interior to minimize temperature transfer. This provides industry accepted performance for condensation resistance and energy performance.

Using the same design, assembly, and accessories as the 14000 center glazed system allows combining inboard, outboard and center planes of glass in the same elevation with the same great performance.



**Standard Medium  
Stile Entrances**

**ALSO  
USED  
WITH**

**200 Series  
Curtainwall**

**TUBELITE®**  
**DEPENDABLE**

LEADERS IN ECO-EFFICIENT STOREFRONT,  
CURTAINWALL AND ENTRANCE SYSTEMS

## 14000 I/O Series Multiplane Storefront Framing

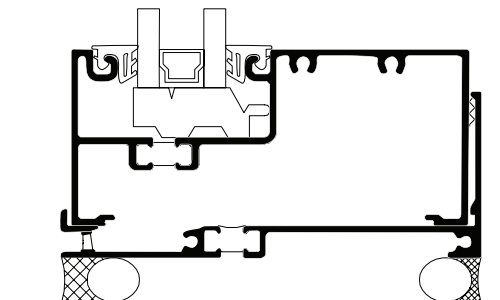
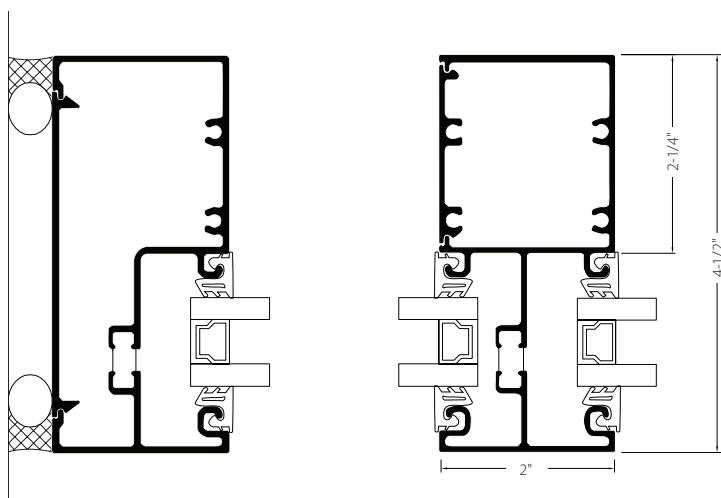

### System Features:

- Standard 2" (50.8mm) sight-line on verticals and horizontals
- 4-1/2" (114.3mm) system depth
- Single Pour & Debridge thermal break with Azon's Lancer® mechanical lock
- EPDM wedge type gaskets for 1" glass or panel thickness

### Optional Features:

- Screw-spline or shear block connections
- Steel reinforcing if required
- Easily integrates with standard or thermal doors, operable vent windows & sun shades
- 7 anodized and 19 painted standard finishes
- Curved Headers
- Non-thermal Framing
- In-board, Centered, or Out-board glass plane
- Silicone Glazed Vertical



### 14000 I/O Series Product Specifications

See Tubelite's Test Reports for mock up sizes and test conditions.

**Application:** Low-rise commercial buildings: retail, office, healthcare, schools, etc

**Description:** 2" x 4-1/2" multiplane outside or inside flush glazed storefront

Face Width:	System Depth:	Glass:	Air Infiltration:	Water Infiltration:	Structural:	CRF:	U-Value:	Acoustic:
2"	4-1/2"	1" std (1/8" - 1-1/8")	0.06 CFM/Ft.2 @ 6.24 PSF	10 PSF - Inside Plane 12 PSF - Outside Plane	30 PSF - Design 45 PSF - Overload	52 <sub>F</sub> 61 <sub>G</sub> - Inside Plane 67 <sub>F</sub> 69 <sub>G</sub> - Outside Plane 64 <sub>F</sub> 63 <sub>G</sub> - Outside Plane SSG	0.33 - Inside Plane 0.35 - Outside Plane 0.32 - Outside Plane SSG	STC 32 OITC 26

DISCLAIMER: Tubelite takes no responsibility for product selection or application, including, but not limited to, compliance with building codes, safety codes, laws, merchantability or fitness for a particular purpose; and further disclaims all liability for the use, in whole or in part, of this Technical Guide in preparation of project specifications and/or other documents. Technical Guides are subject to change at any time, without notice, and at Tubelite's sole discretion. ©2017 Tubelite Inc.

090118

# TUBELITE®

**DEPENDABLE**

LEADERS IN ECO-EFFICIENT STOREFRONT,  
CURTAINWALL AND ENTRANCE SYSTEMS