

300ES High Performance Thermal Curtainwall

A break from high energy costs!

Tubelite 300ES Curtainwall Series Framing is designed for superior thermal performance using Therm=Block insulbar technology, featuring System U-Factor as low as 0.31 and Condensation Resistance Factor (CRF) up to 81 using 1" insulating glass.

The exterior face has a 2-1/4" sightline and available in 6" and 8" depths. Ideal for curtainwall applications up to four stories and the inside glazing feature offers reduced field installation time and expense.

Separate interior and exterior frame members allow different finishes on each.

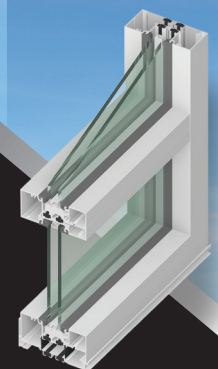
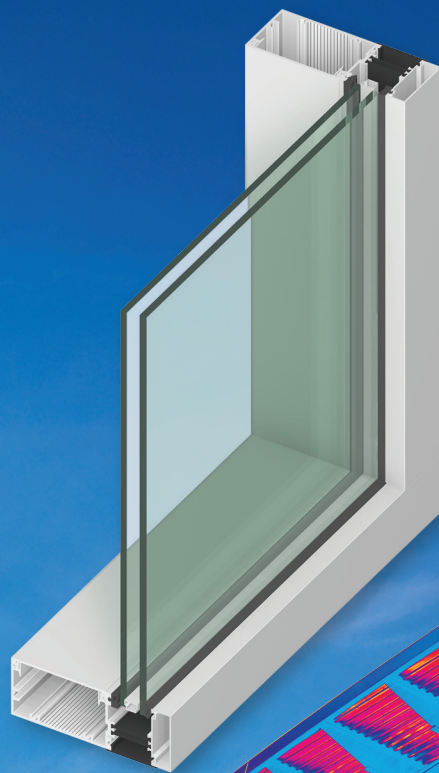
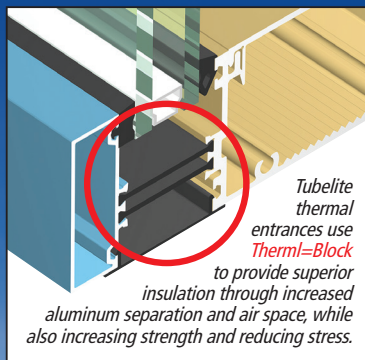

TU24000 High Thermal Performance Storefront



TerraPorte 7600 Terrace Door

ALSO
USED
WITH

Therm=Block
HIGH PERFORMANCE THERMAL FRAMING



TUBELITE[®]
DEPENDABLE

LEADERS IN ECO-EFFICIENT STOREFRONT,
CURTAINWALL AND ENTRANCE SYSTEMS

300ES Curtainwall Series Framing

ThermalBlock
HIGH PERFORMANCE THERMAL FRAMING

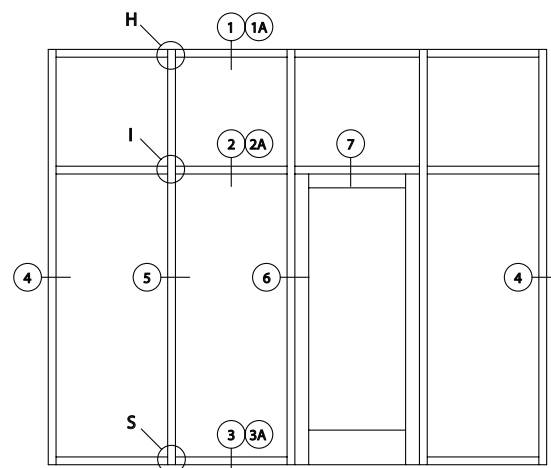
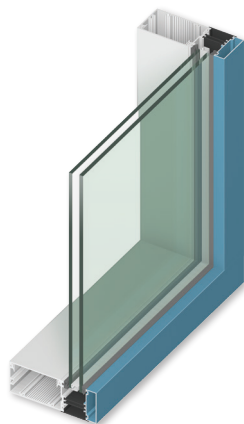

Outside Glazed

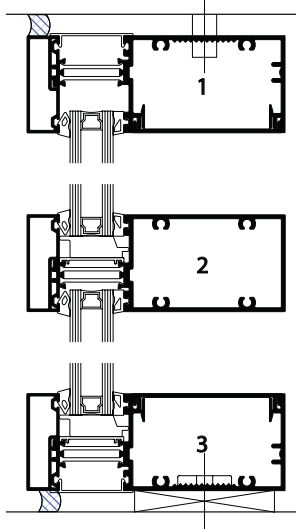

Inside Glazed

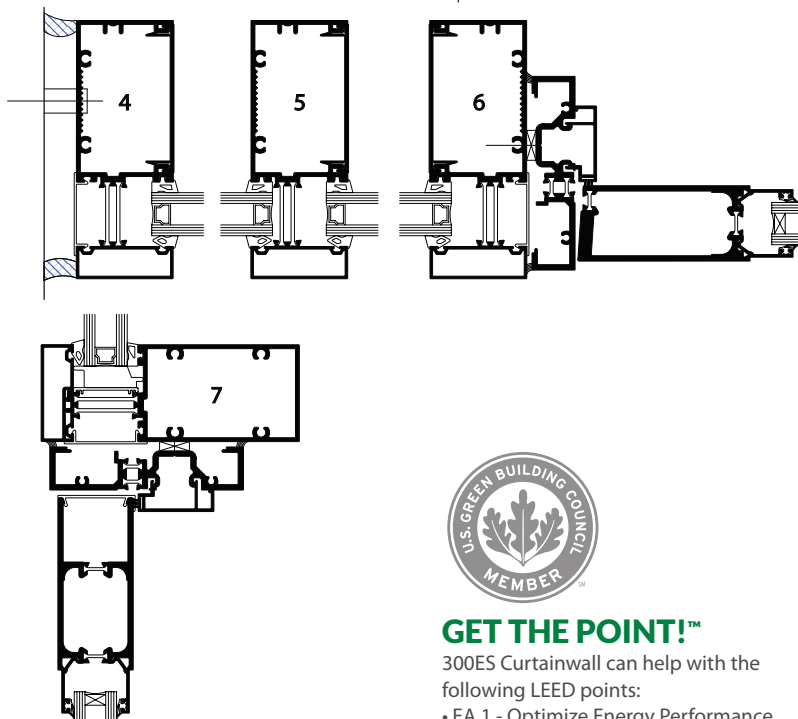
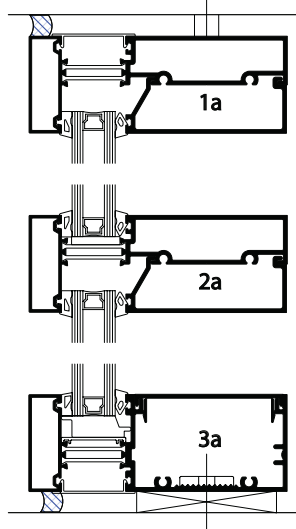

System Features:

- 31% reduction in thermal transmittance (Uc) over pressure bar curtainwall systems – Tubelite 400 Series
- Dynamic water testing to 15 psf
- Fast, easy screw spline assembly saves labor and cost
- Blocks interior frost buildup
- Inside and outside glazing options
- Recycled Aluminum Extrusion Option - www.EcoLuminum.com
- Use with Tubelite's Medium or Wide Stile Thermal Door for a complete thermal wall system.
- Different color painted and anodized finishes can be selected for interior and exterior surfaces.



GET THE POINT!™

300ES Curtainwall can help with the following LEED points:

- EA 1 - Optimize Energy Performance
- MR 4.1 & 4.2 Recycled Content
- EQ 6.2 Thermal Comfort
- EQ 8.1 & 8.2 Daylight & Views

300ES Series Product Specifications

See Tubelite's Test Reports for mock up sizes and test conditions.

Application: Low and mid-rise commercial buildings including retail, office, healthcare, schools, etc.

Description: 2-1/4" x (6" or 8") inside or outside glazed, screw spline high performance curtainwall

Face Width:	Overall Depths:	Glass:	Air Infiltration:	Water Infiltration:	Structural:	U-Value:	CRF:	Acoustic:
2-1/4"	6", 8"	1"	0.06 CFM/Ft.2 @ 6.24 PSF	15 PSF – Static 15 PSF – Dynamic	40 PSF – Design 67.5 PSF – Overload	0.30 – 6" 0.31 – 8"	72 – 6" 81 – 8"	31 STC 26 OITC

DISCLAIMER: Tubelite takes no responsibility for product selection or application, including, but not limited to, compliance with building codes, safety codes, laws, merchantability or fitness for a particular purpose; and further disclaims all liability for the use, in whole or in part, of this Technical Guide in preparation of project specifications and/or other documents. Technical Guides are subject to change at any time, without notice, and at Tubelite's sole discretion. ©2015 Tubelite Inc.

090118

TUBELITE®
DEPENDABLE

LEADERS IN ECO-EFFICIENT STOREFRONT,
CURTAINWALL AND ENTRANCE SYSTEMS