



# AC8000A

BARN DOOR HARDWARE

## SPECIFICATIONS

Max door weight:  
220 lbs

Track length comes in 2 lengths:  
2M and 2.5M

Dual-Soft Close:  
MINIMUM door size for application is 23 5/8" wide

Available Finishes: Matte Black ● Polished ● Brushed ● Satin Brass ●

Custom finishes available

Architectural  
Concepts

O (888) 248 2724  
E info@archconceptsllc.com

18505 Longs Way  
Parker, CO 80134

[archconceptsllc.com](http://archconceptsllc.com)

## HARDWARE





# AC8000A

78" BARN DOOR HARDWARE

## ELEVATION

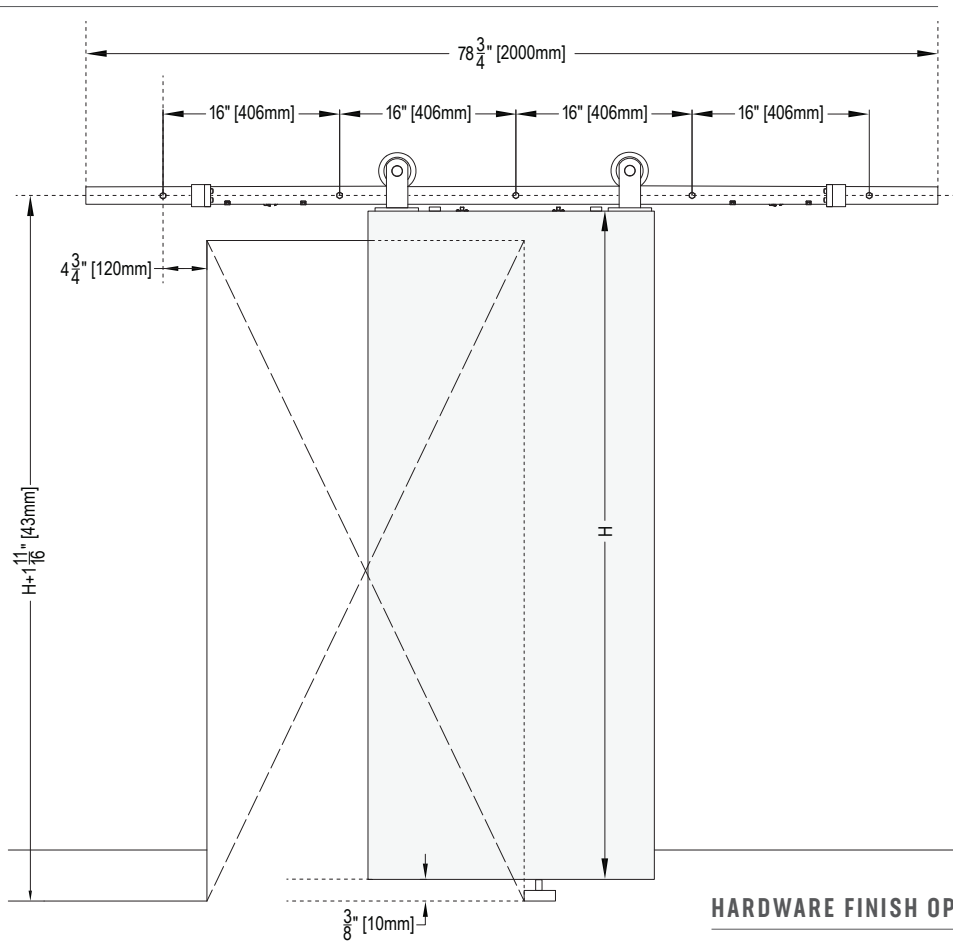

## HARDWARE FINISH OPTION

Available Finishes: Matte Black  Polished  Brushed  Satin Brass 

Custom finishes available

Architectural  
Concepts

O (888) 248 2724  
E info@archconceptsllc.com

18505 Longs Way  
Parker, CO 80134

[archconceptsllc.com](http://archconceptsllc.com)

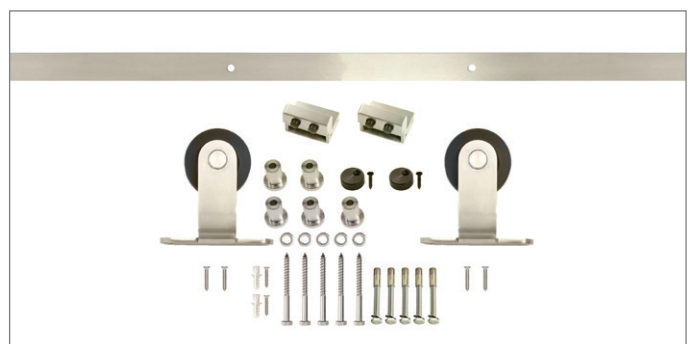



# AC8000A

98" BARN DOOR HARDWARE



## ELEVATION

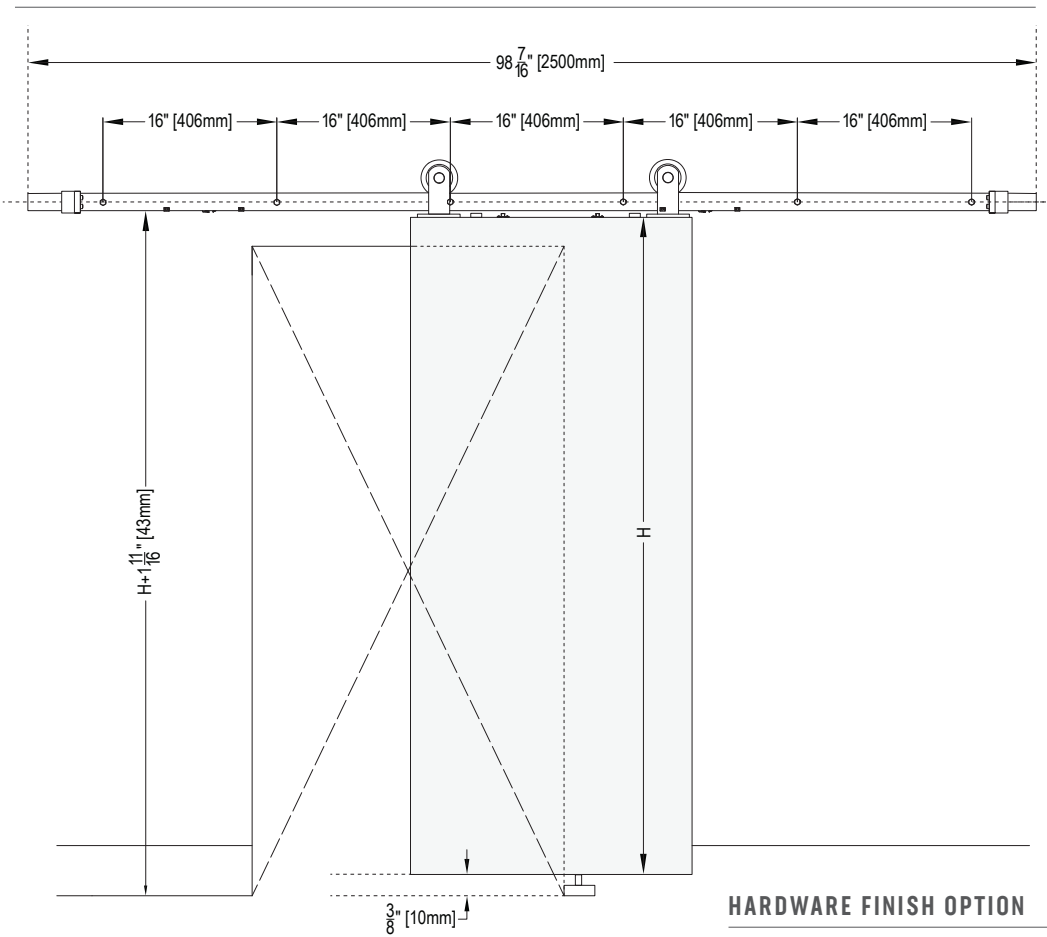

## HARDWARE FINISH OPTION

Available Finishes: Matte Black  Polished  Brushed  Satin Brass 

Architectural  
Concepts

O (888) 248 2724  
E info@archconceptsllc.com

18505 Longs Way  
Parker, CO 80134

[archconceptsllc.com](http://archconceptsllc.com)

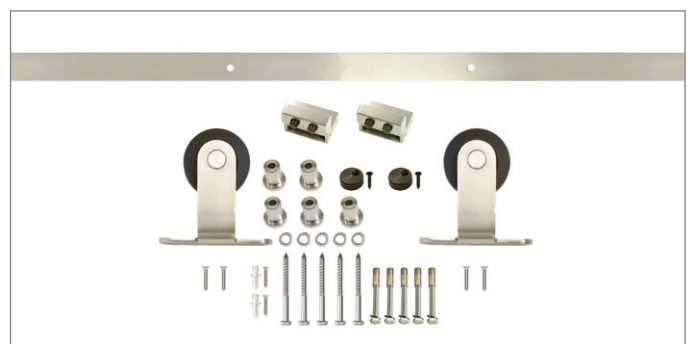

# AC8000A

BARN DOOR HARDWARE

## HANGER ELEVATION SIDE

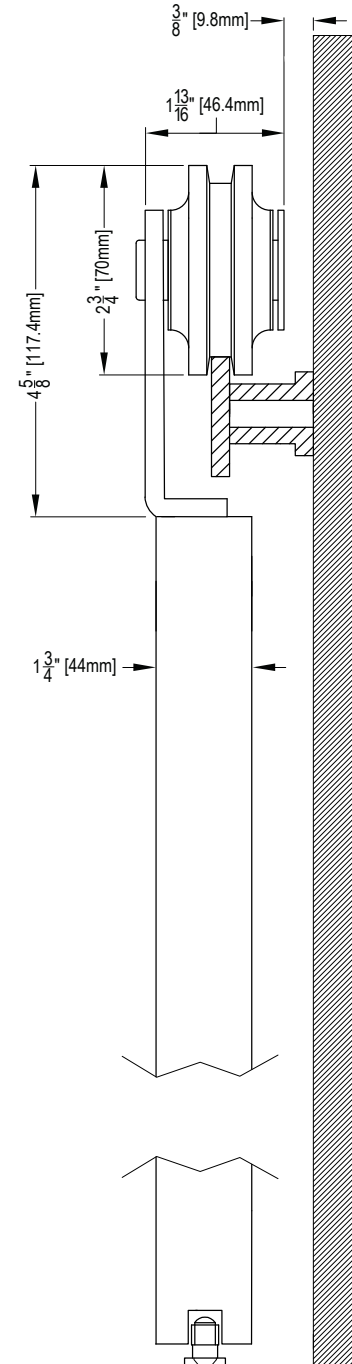

## HARDWARE DIMENSIONS

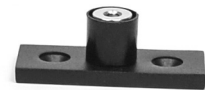
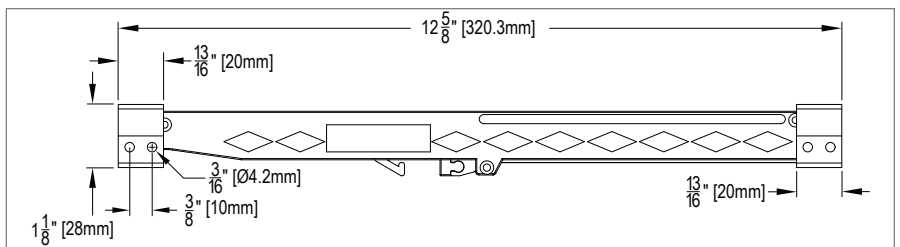
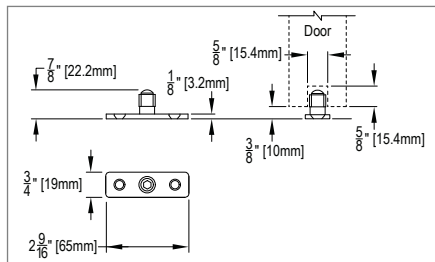
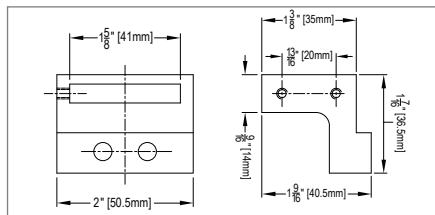
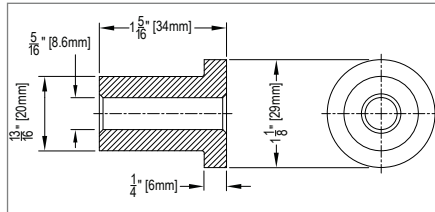
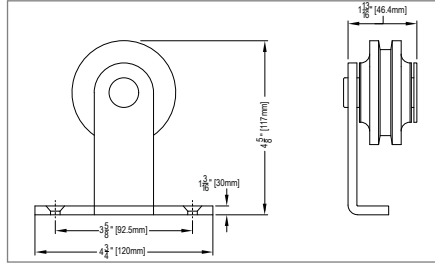

Architectural Concepts

(888) 248 2724 | (720) 259 5358 | info@archconceptsllc.com | 18505 Longs Way, Parker, CO 80134 | archconceptsllc.com