

# Architectural Concepts

## NEWPORT

### Barn Door Shower Enclosure Installation Instructions

**76" OA Height**  
**Fits Standard Opening Range of 54" - 60"**

*Customization Options Available*

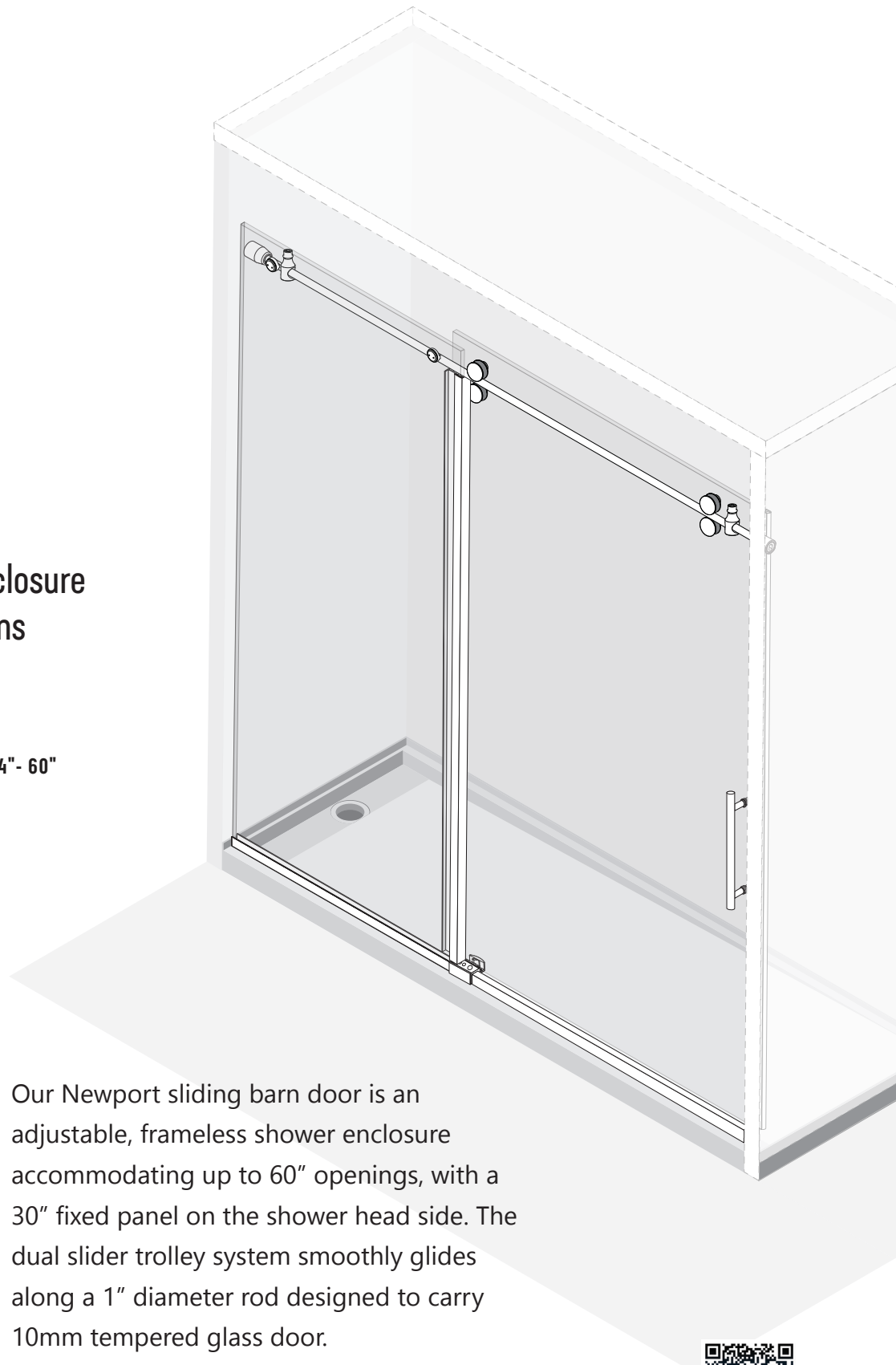

Our Newport sliding barn door is an adjustable, frameless shower enclosure accommodating up to 60" openings, with a 30" fixed panel on the shower head side. The dual slider trolley system smoothly glides along a 1" diameter rod designed to carry 10mm tempered glass door.



HARDWARE INCLUDED

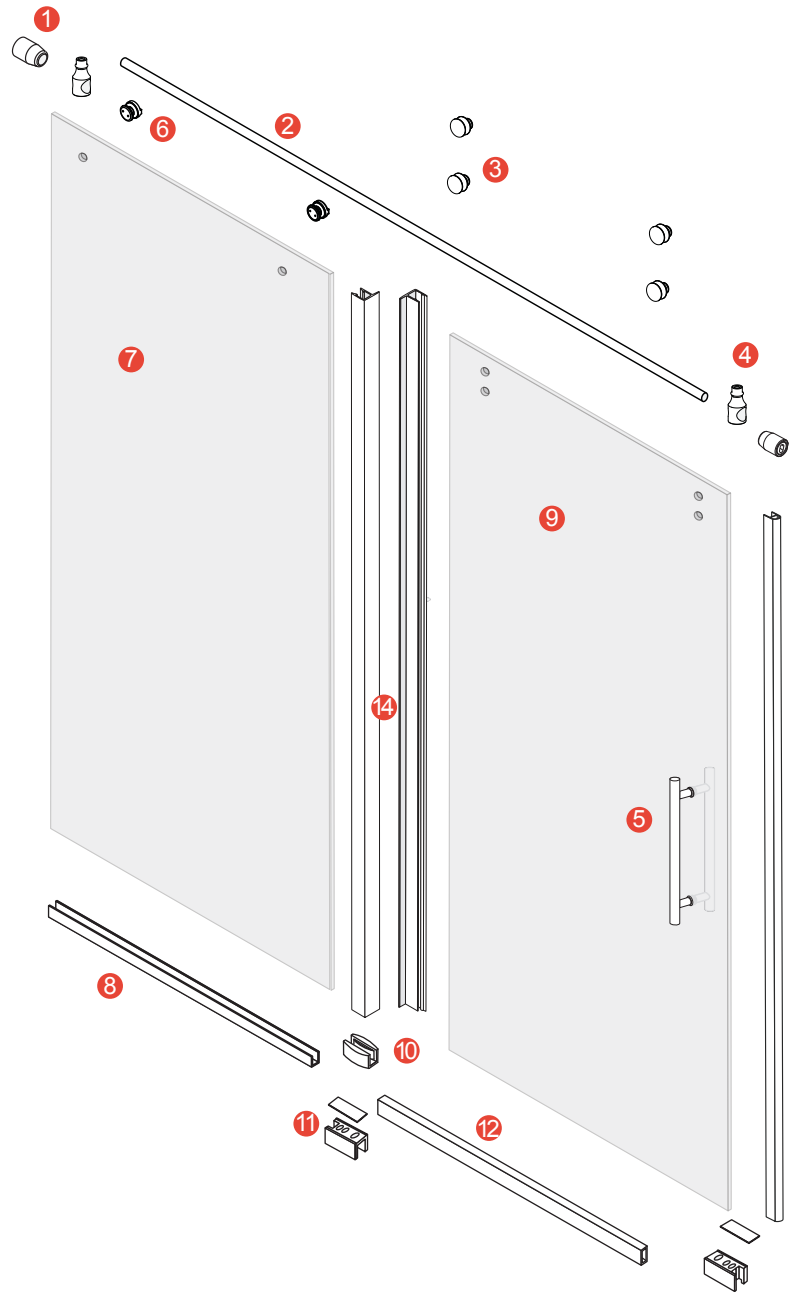
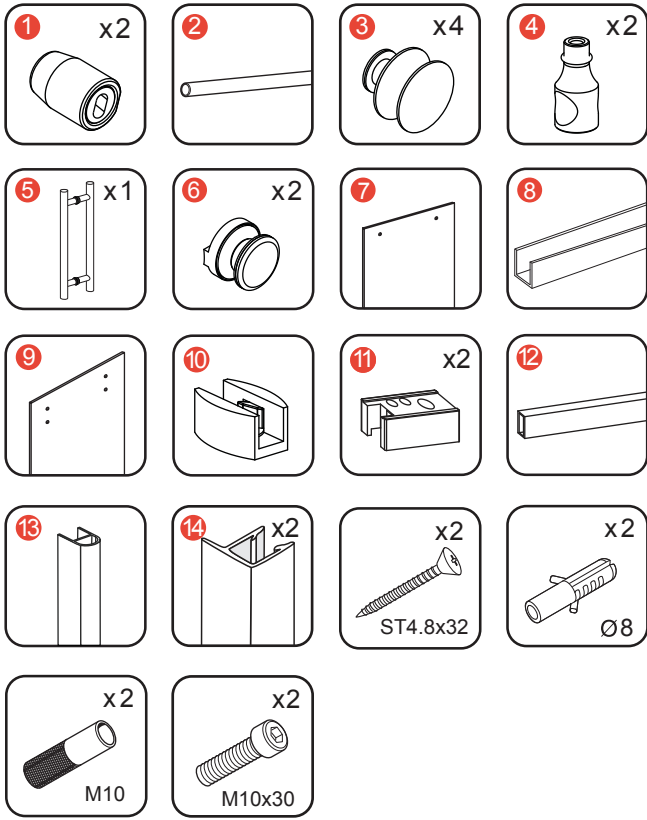

TOOLS NEEDED

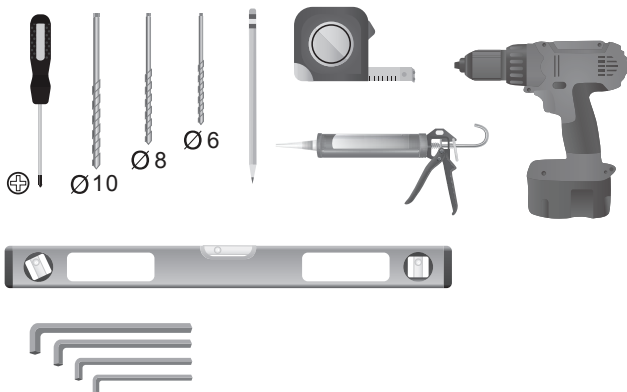

**Step 1**

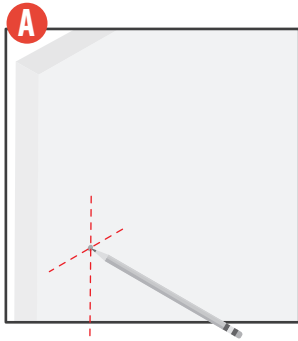

**A.1**  
Measure.  
Standard height  $H=76''$   
Hole location is  
 $H - 2 \frac{3}{4}''$ , mark hole  
at  $73 \frac{1}{4}''$

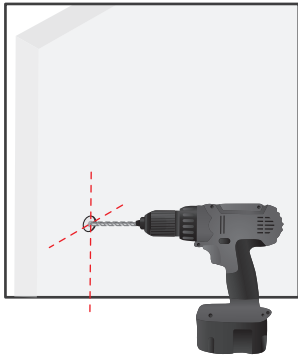

**A.2**  
Drill holes. Note:  
Hole should be  $\frac{3}{8}''$   
(10mm) in diameter.  
The mounting  
bracket will give you  
about a  $\frac{1}{4}''$  play up  
or down for the rod

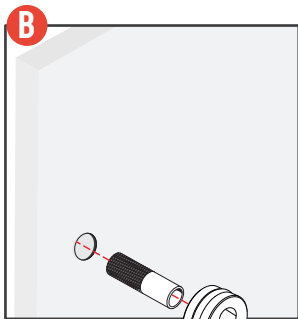

**B.1**  
Ensure that there is  
proper blocking for  
expansion bolts to  
mount through. If  
not, the expansion  
bolts will not grip.

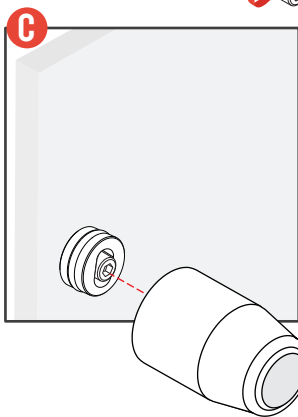

**C.1**  
Attach rod mount

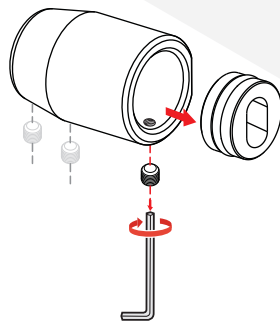

Provide thread-lock  
glue (Loc-Tile)

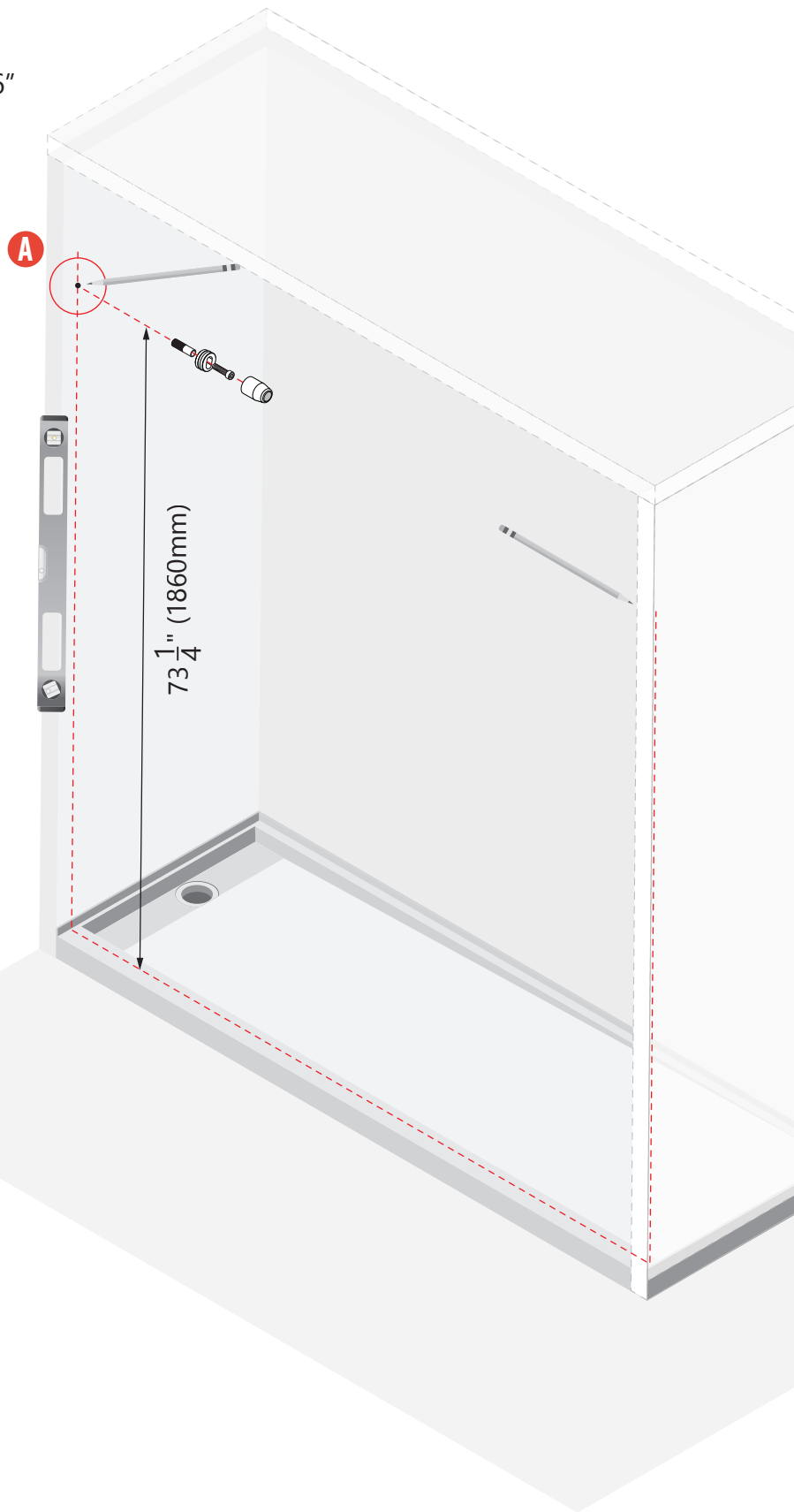

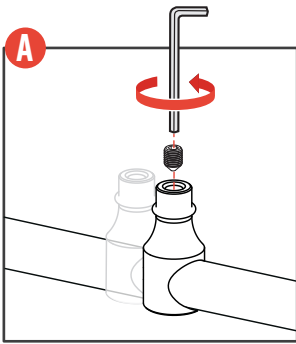
**Step 2**

**A.1**  
Slide door stops  
onto rod and  
position accordingly

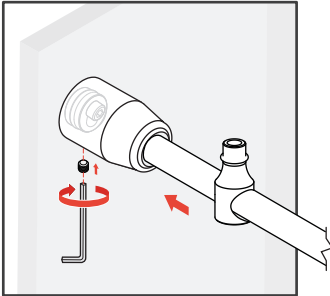

**A.2**  
Tighten set screws  
and secure with  
loc-tite once rod is in  
desired position

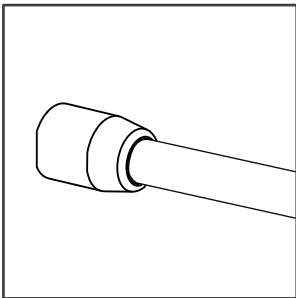

**A.3**  
Make sure that the  
flat side of rod  
mount faces out to  
allow glass panel  
door to fully operate.

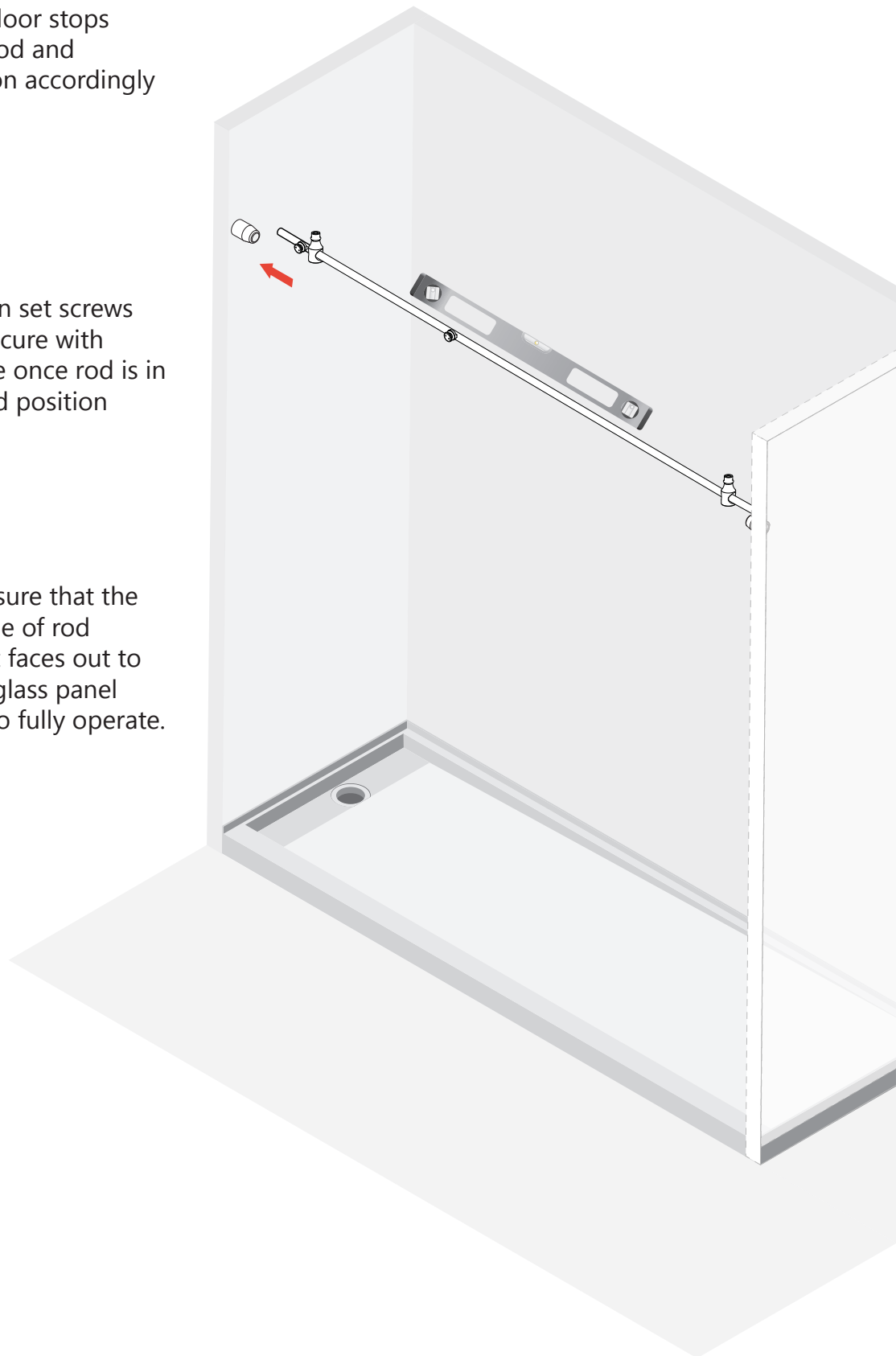

**Step 3**

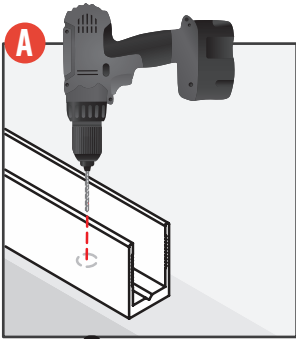

**A.1**  
Mark and drill holes

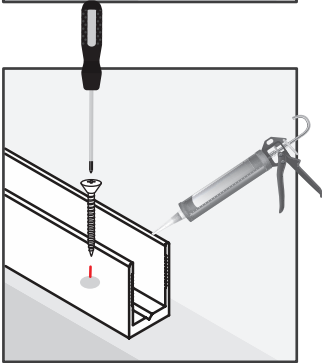

**A.2**  
After mounting U-channel, silicone over the top of any fasteners used inside the channel prior to glass installation to seal any penetrations

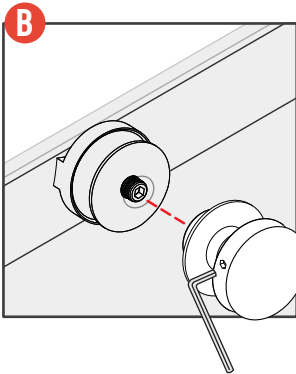

**B.1**  
Mount fixed panel to brackets on rod

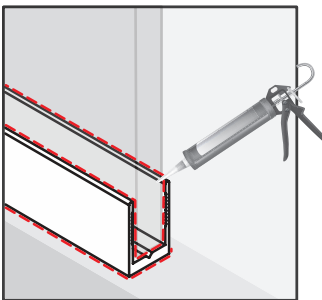

**B.2**  
and drop panel into U-channel. Silicone both sides of the U-channel to the glass, and silicone the channel to the curb inside and out

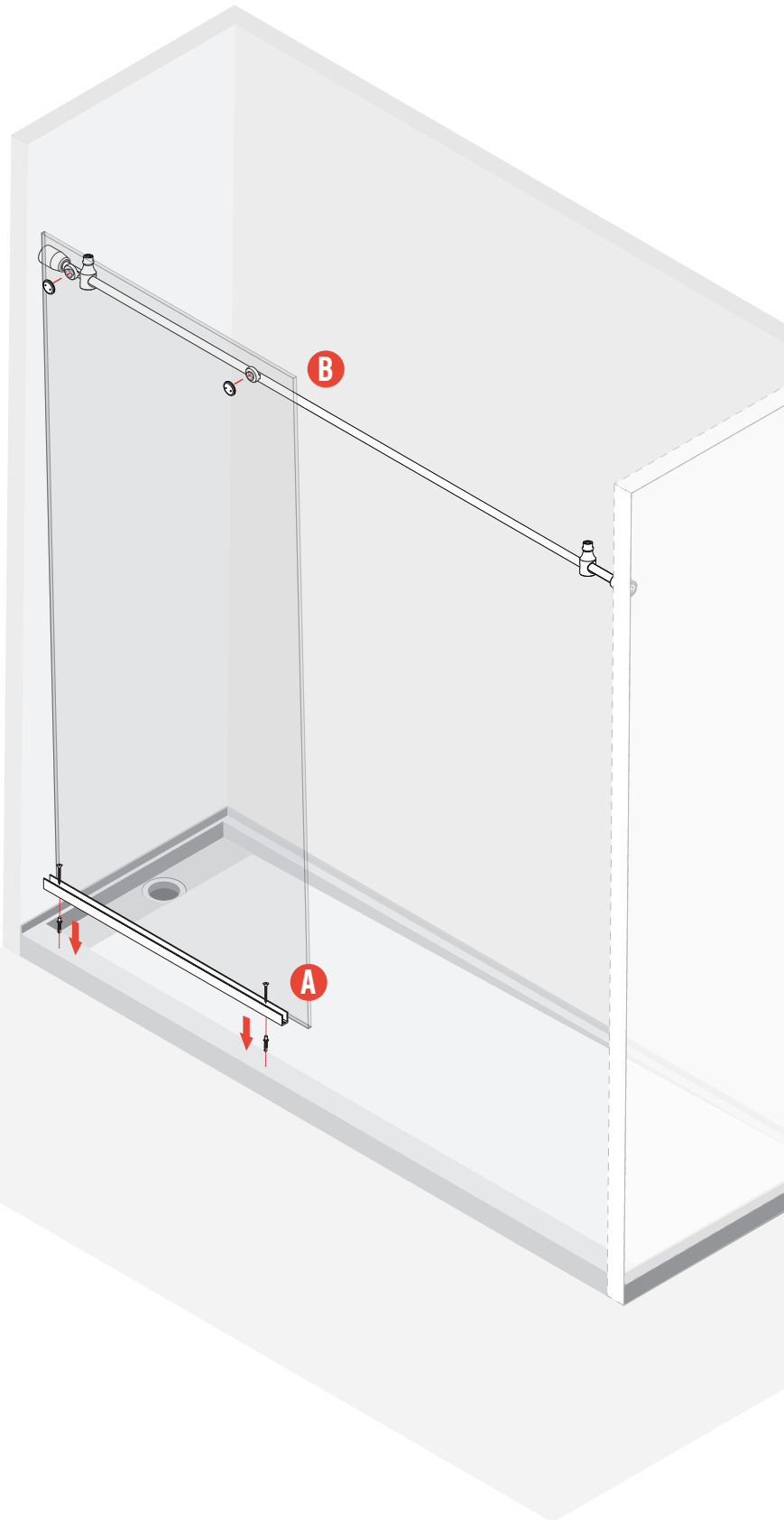

**Step 4**

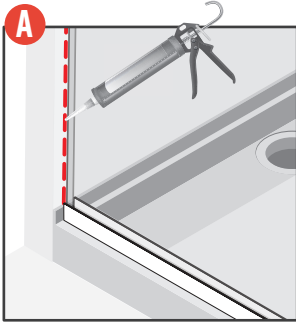

**A.1**  
Silicone glass to wall on vertical edge.

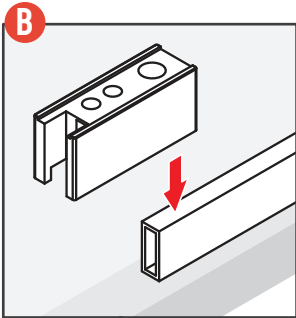
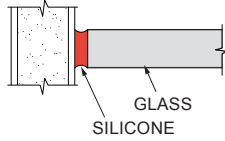

**B.1**  
Insert rollers on to rails as pictured before attaching to glass doors.

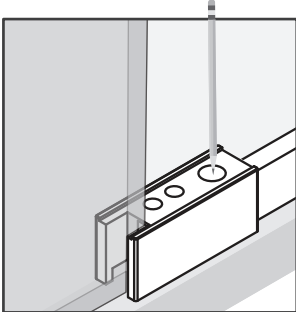

**B.2**  
Water dam is recommended for optimal performance. The sliding door must be installed to the interior of the shower in order to use it

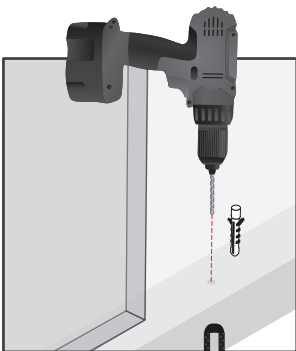

**B.3**  
Drill holes and insert anchor

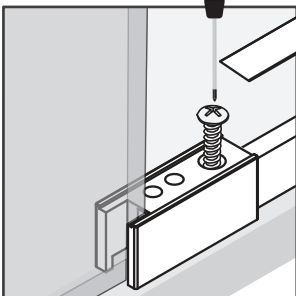

**B.4**  
Insert screw and silicone over the top of fastener to seal any penetrations. Apply cover

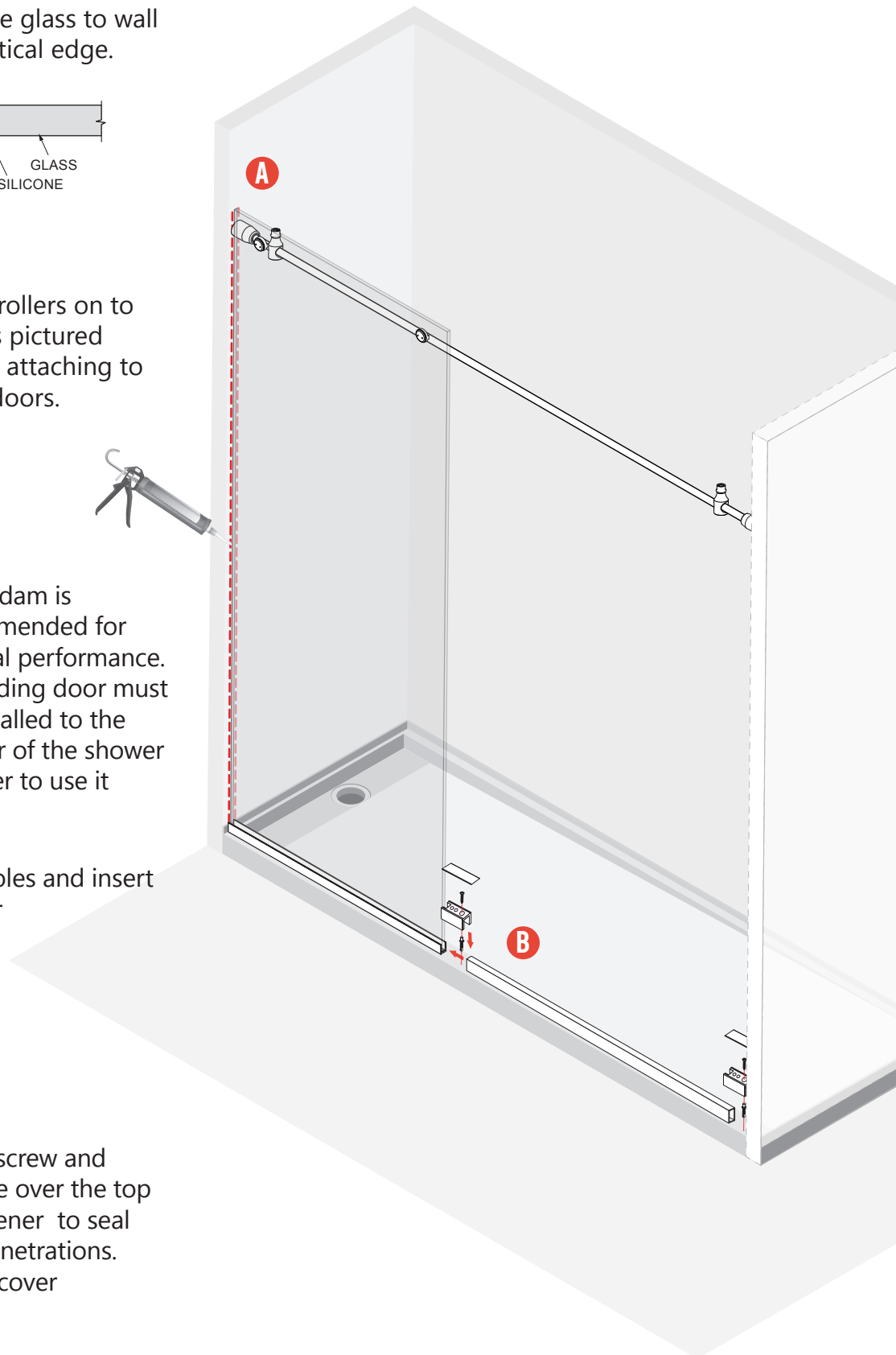

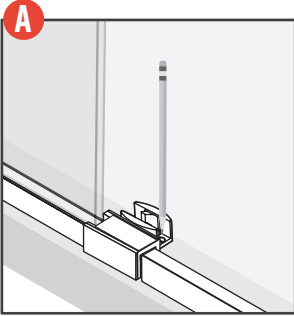
**Step 5****A.1**

Floor guide goes inside of the water dam and U-channel. Place and mark holes

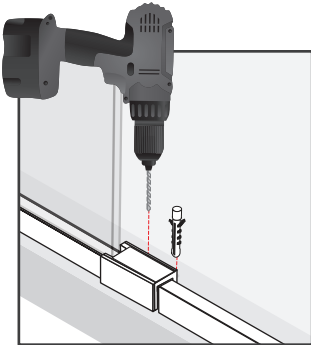
**A.2**

Drill holes and insert anchors for screws

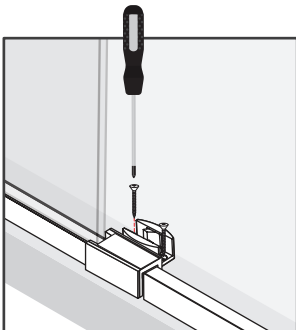
**A.3**

Mount floor guide and silicone over the top of fastener to seal any penetrations

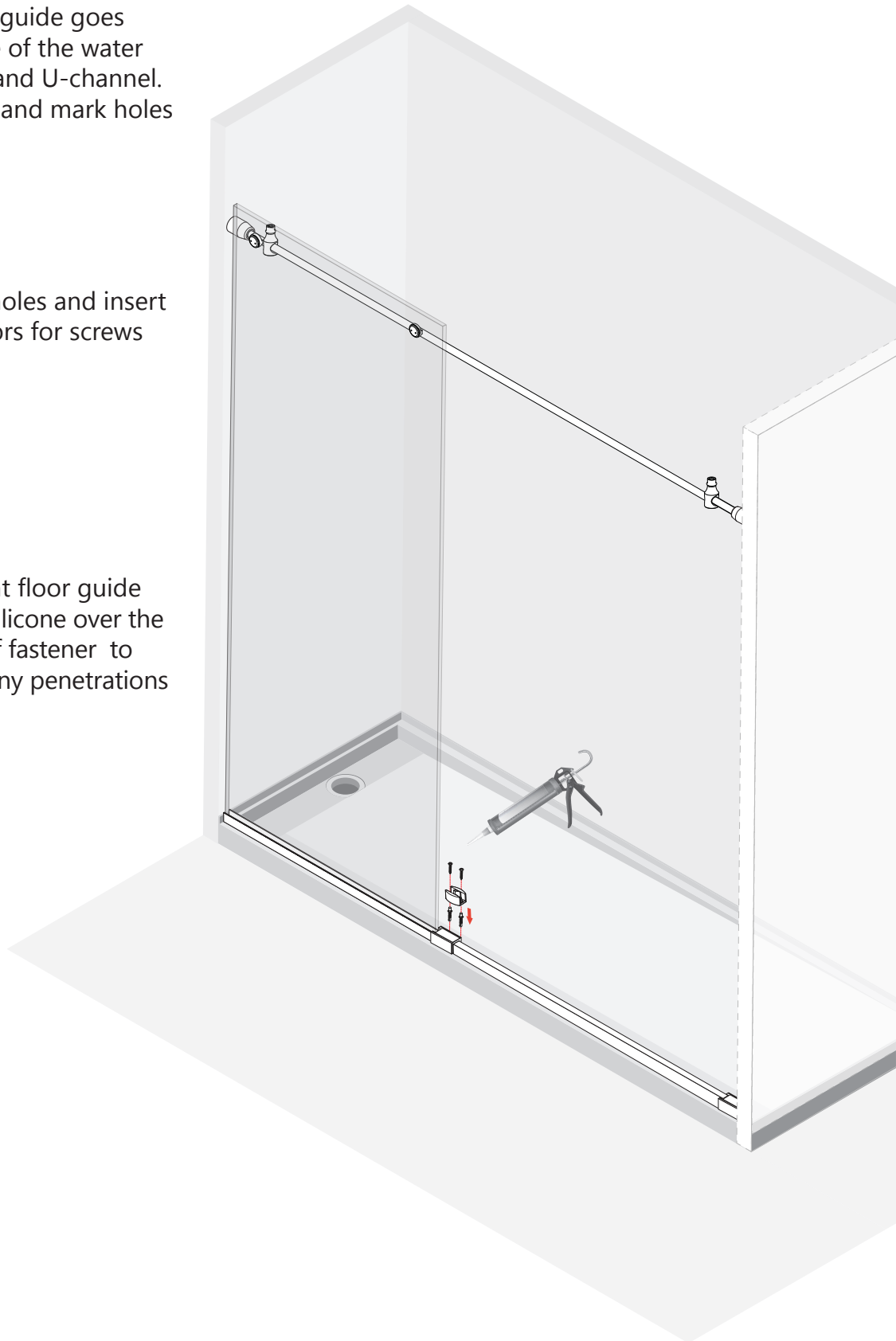

**Step 6**

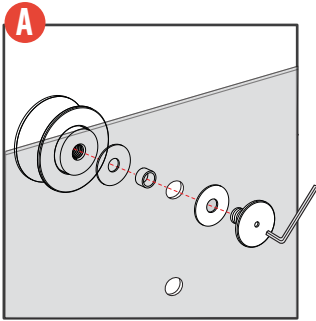

**A.1**

The four barn door trolleys include an offset grommet held in by a pin. This grommet will allow you to adjust the vertical and horizontal plumb about 1/4", by twisting the back side of the trolley.

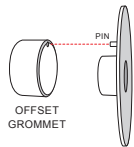

**!** Attention:  
Take care not to break off the pin

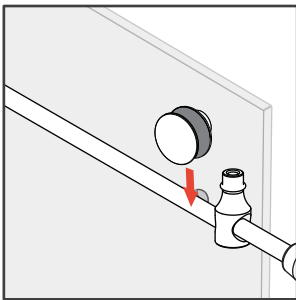

**A.2**

Hang glass door onto rod

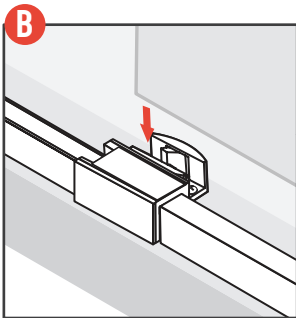

**B.1**

Align bottom guide to allow glass to run in a plumb condition

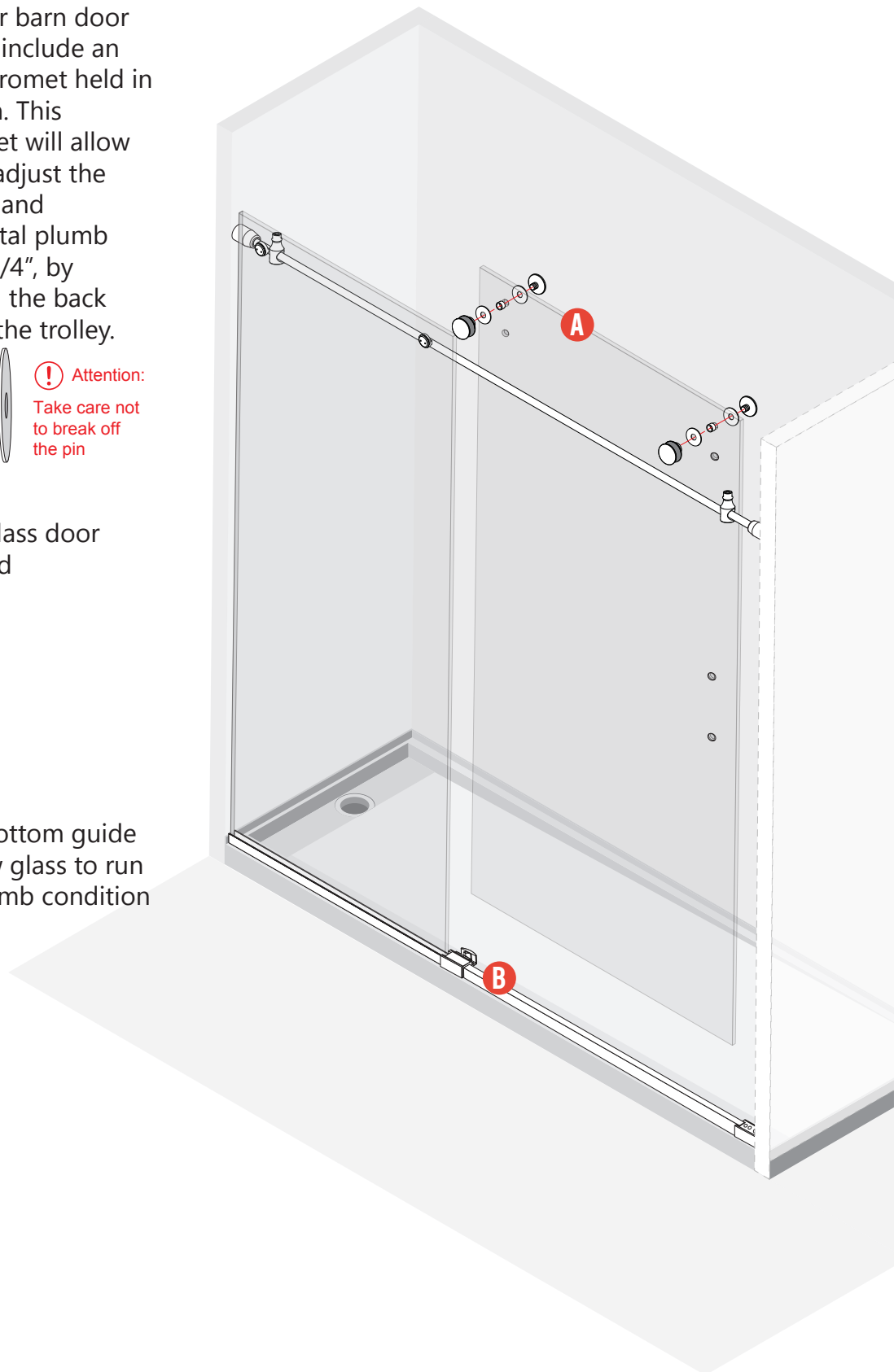



**Step 6**

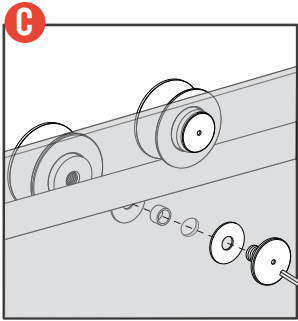

**C.1**  
Install the bottom rollers using the same steps as the top

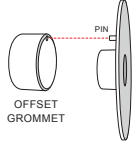

**!** Attention:  
Take care not to break off the pin

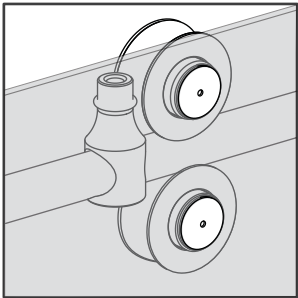

**C.2**

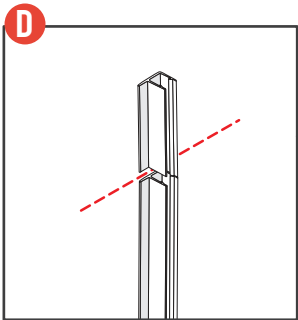

**D.1**  
Trim seal to fit just below rod

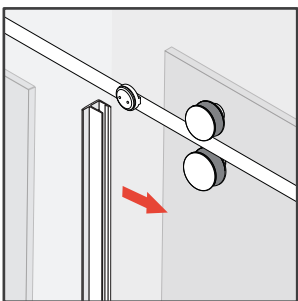

**D.2**  
Trim and install seals for best performance against water escape and protection of glass edge  
Align seal to ride just below track

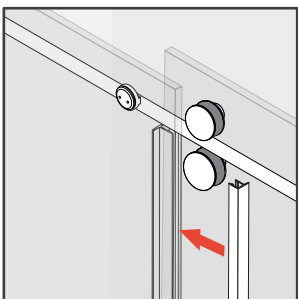

**D.3**

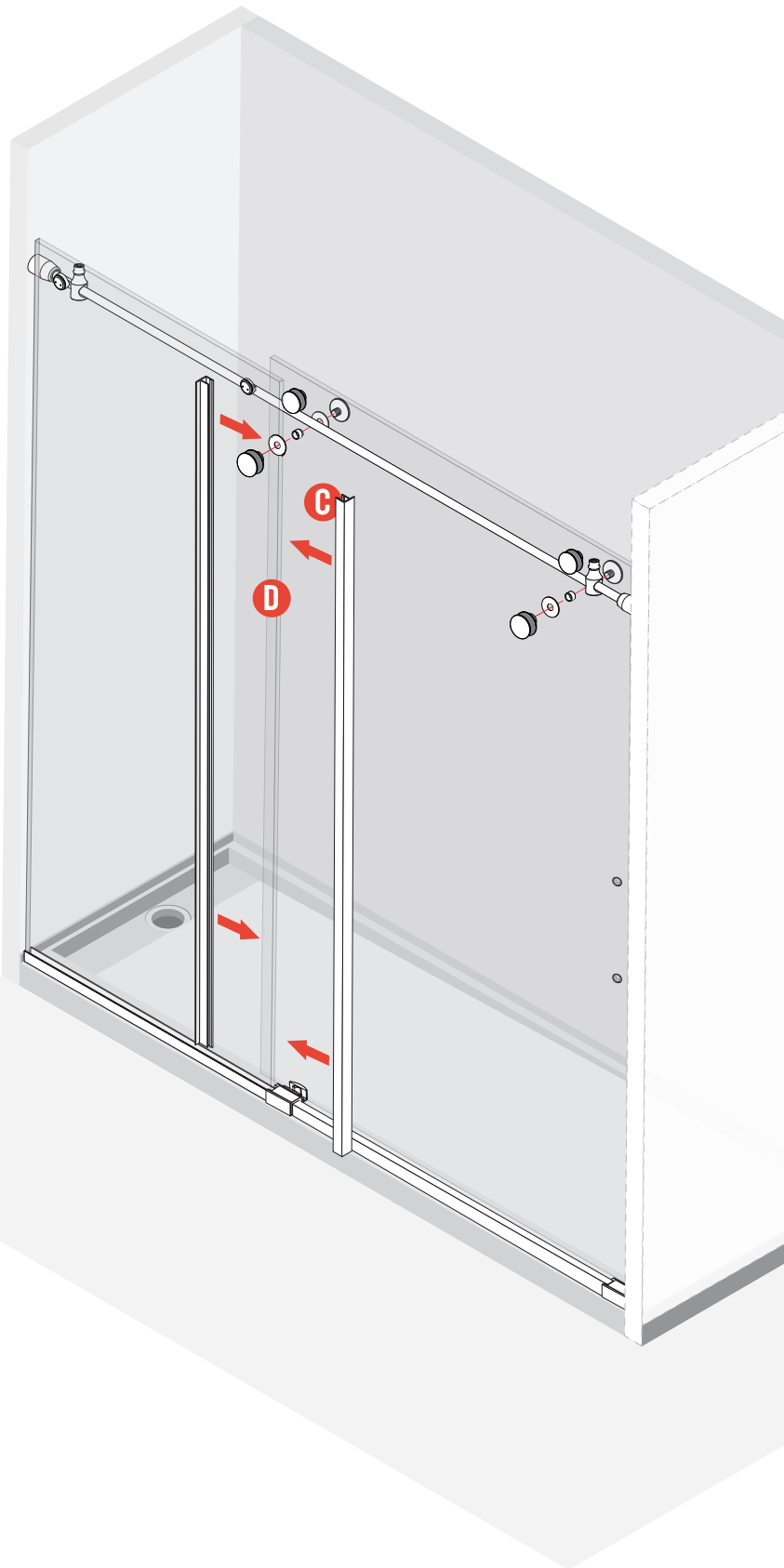

**Step 7**

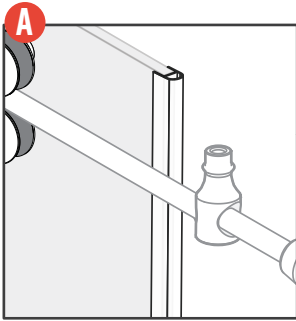

**A.1**  
Apply seal to glass door

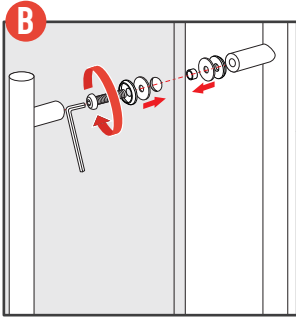

**B.1**  
Install BTB pull

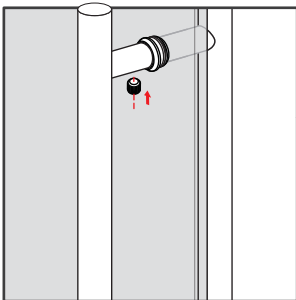

**B.2**  
Install BTB pull

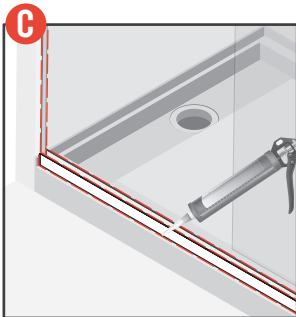

**C.1**  
To complete install and prevent leakage run silicone inside and out along the u-channel and water dam  
Double check the glass panel-to-wall seal

