



DC

A door company that is
Clearly Different
than the rest

Architectural Concepts / Door Collection

P202

PANEL LITE DOOR

PROFILES

STICKING

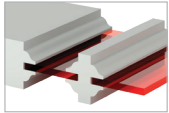

ROMAN OGEE SASH (OG)

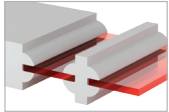

QUARTER ROUND SASH (QR)

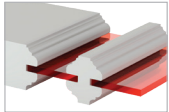

COVE & BEAD SASH (CB)

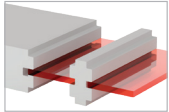

ONE STEP SASH (OS)

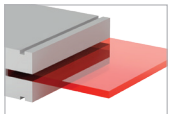

QUIRK MOLDING COMPRESSION FIT (QM)

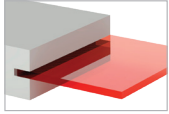

SQUARE STICK COMPRESSION FIT (SS)

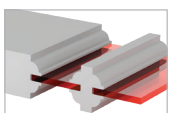

QUARTER BEAD SASH (QB)

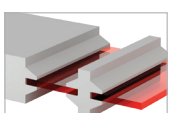

BEVEL SASH (BV)

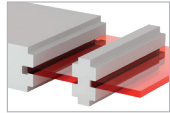

SQUARE STICK SASH (SS)

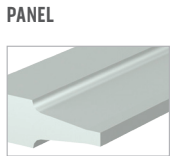

PANEL

RAISED (R)

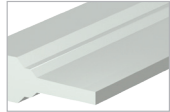

DOUBLE HIP (D)

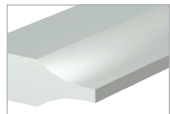

SCOOP (S)



JUNIOR BEVEL (JR)

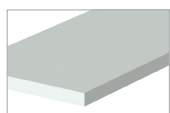

FLAT (F)



SENIOR RAISED (SR)

MOULDINGS

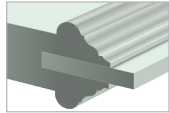

AC-001

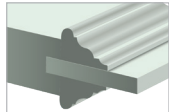

AC-002

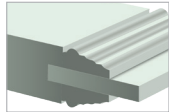

AC-003

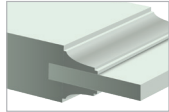

AC-004

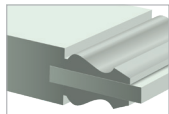

AC-005

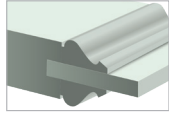

AC-006

STYLE

PANEL

PANEL LITE (PL)

FRENCH (FL)

V-GROOVE (VG)

FLUSH (FM)

LOUVER (LVR)

MATERIAL

MDF

WOOD

OPTIONS

FIRE-RATED 20 MIN ▼

INSERTS

MIRROR 1-SIDE ▼

GLASS SELECT ▼

RESIN

ELEVATION

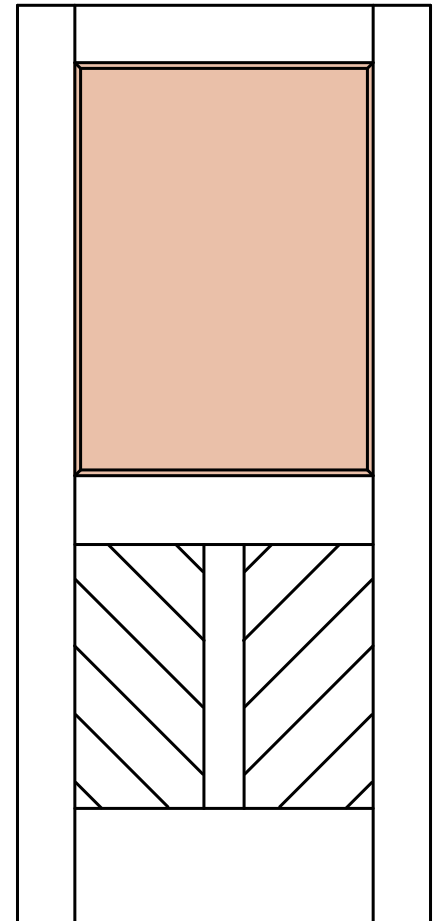

**Architectural
Concepts**

Customer Service
(720) 882 9179
quotes@archconceptsllc.com
orders@archconceptsllc.com

18505 Longs Way
Parker, CO 80134

archconceptsllc.com