



# DC

*A door company that is*  
**Clearly Different**  
*than the rest*

## Architectural Concepts / Door Collection

# P309

PANEL LITE DOOR

### PROFILES

#### STICKING

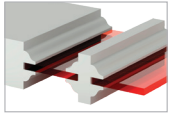

ROMAN OGEE SASH (OG)

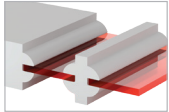

QUARTER ROUND SASH (QR)

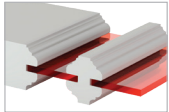

COVE & BEAD SASH (CB)

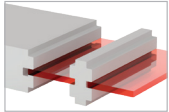

ONE STEP SASH (OS)

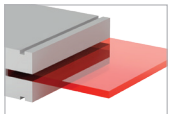

QUIRK MOLDING COMPRESSION FIT (QM)

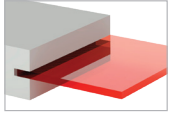

SQUARE STICK COMPRESSION FIT (SS)

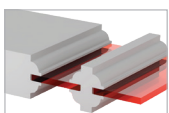

QUARTER BEAD SASH (QB)

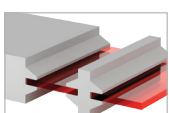

BEVEL SASH (BV)

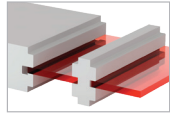

SQUARE STICK SASH (SS)

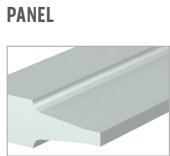

#### PANEL

RAISED (R)

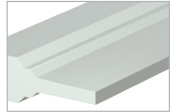

DOUBLE HIP (D)

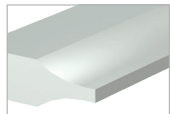

SCOOP (S)



JUNIOR BEVEL (JR)

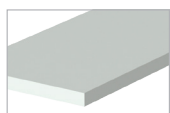

FLAT (F)



SENIOR RAISED (SR)

### MOULDINGS

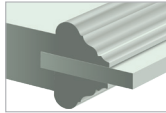

AC-001

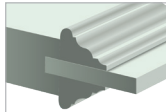

AC-002

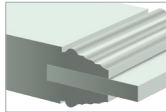

AC-003

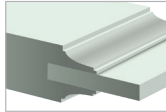

AC-004

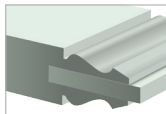

AC-005

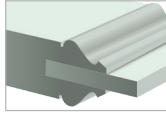

AC-006

### STYLE

#### PANEL

PANEL LITE (PL)

FRENCH (FL)

V-GROOVE (VG)

FLUSH (FM)

LOUVER (LVR)

#### MATERIAL

MDF

WOOD

#### OPTIONS

FIRE-RATED

#### INSERTS

MIRROR

GLASS

RESIN

### ELEVATION

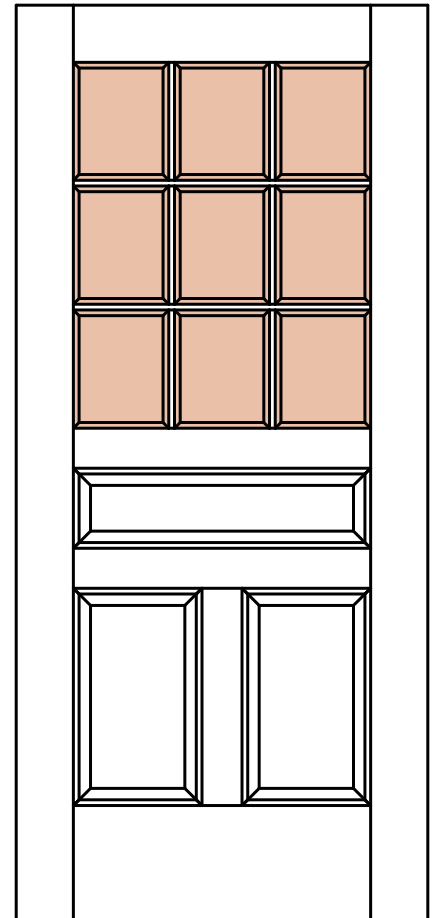

**Architectural  
Concepts**

**Customer Service**  
(720) 882 9179  
quotes@archconceptsllc.com  
orders@archconceptsllc.com

18505 Longs Way  
Parker, CO 80134

[archconceptsllc.com](http://archconceptsllc.com)