

Architectural Concepts

FRESNO

Framed By Pass Shower Enclosure Installation Instructions

76" OA Height
Fits Standard Opening Range of 54" - 60"
Customization Options Available

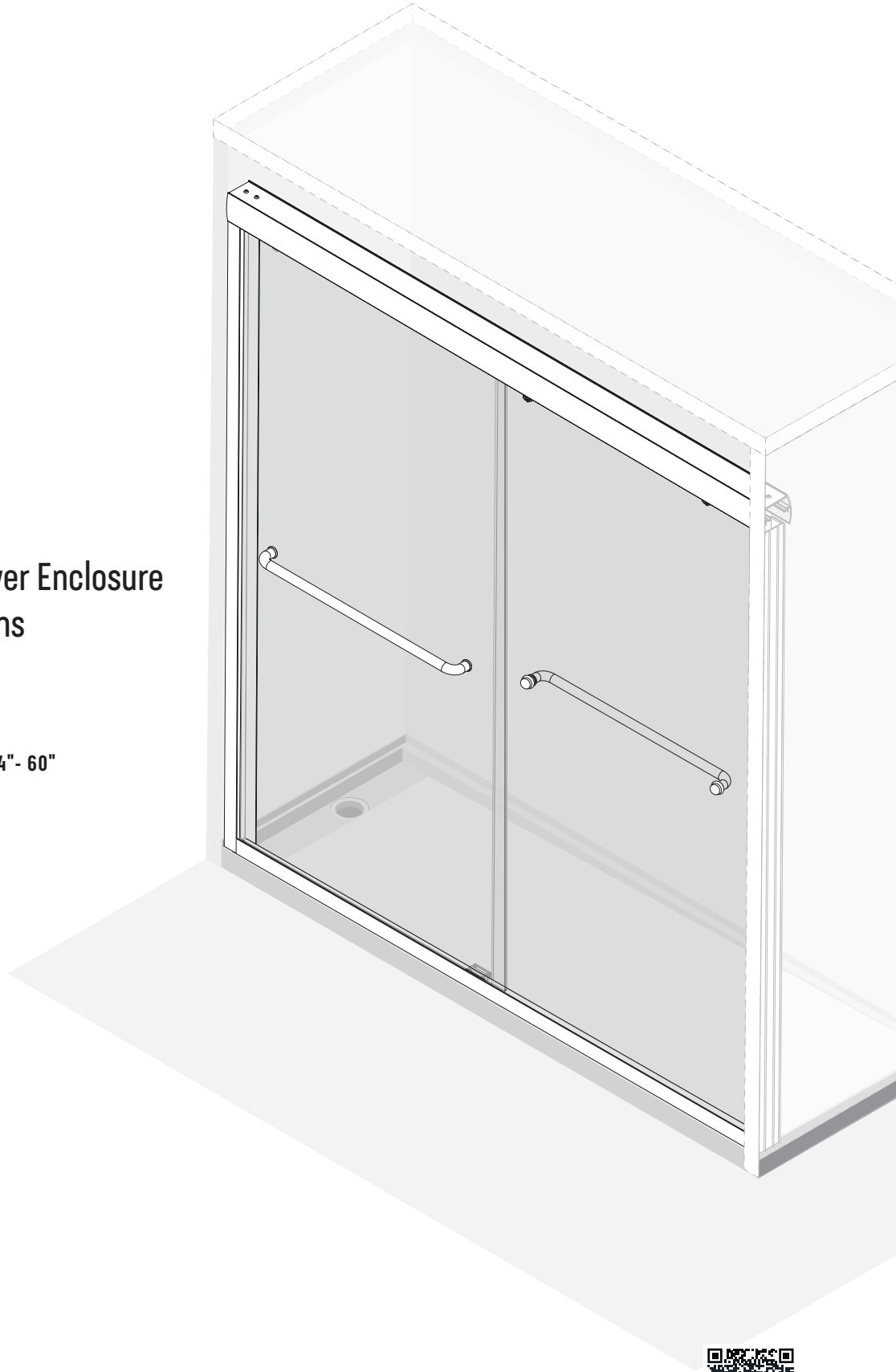

HARDWARE INCLUDED

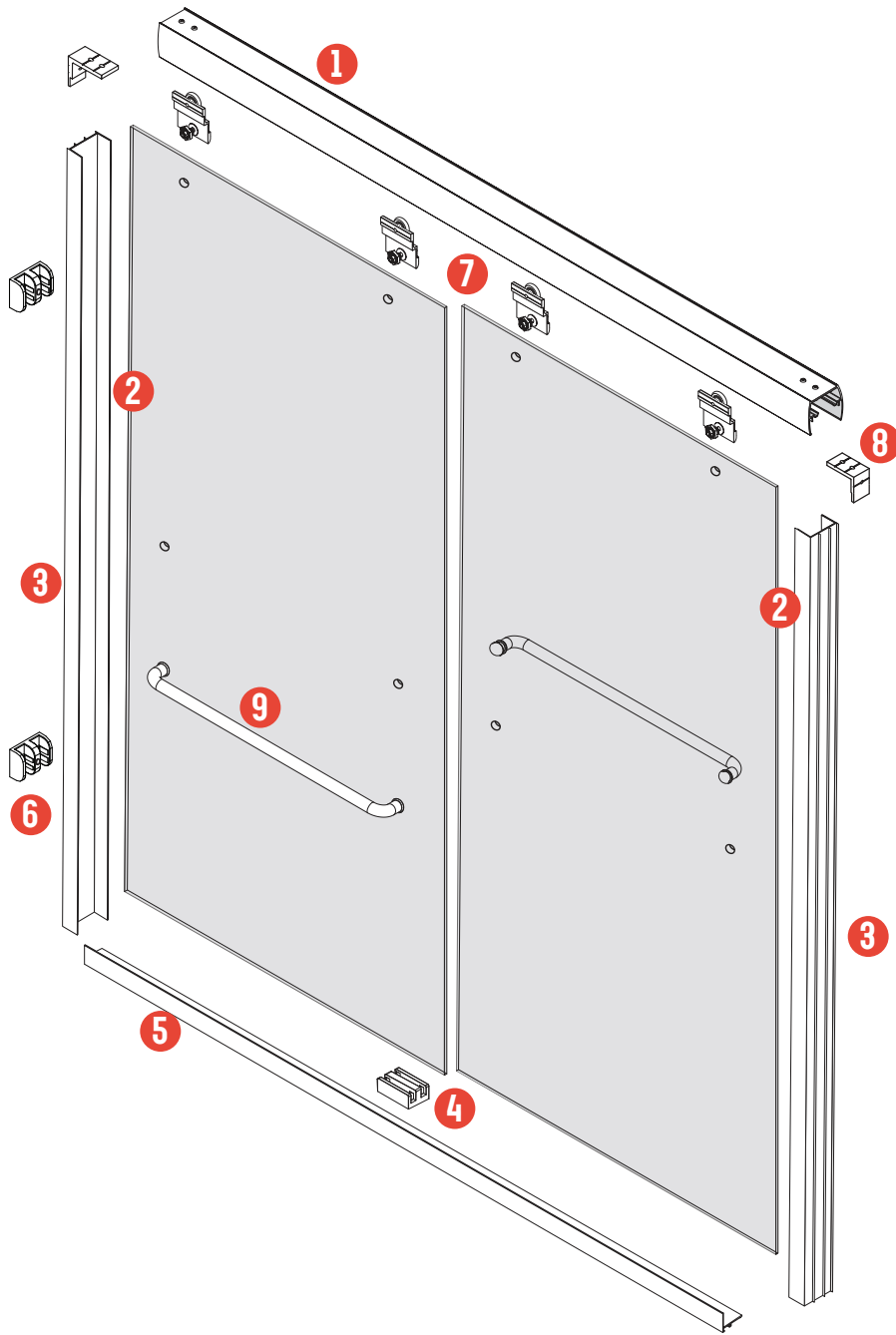
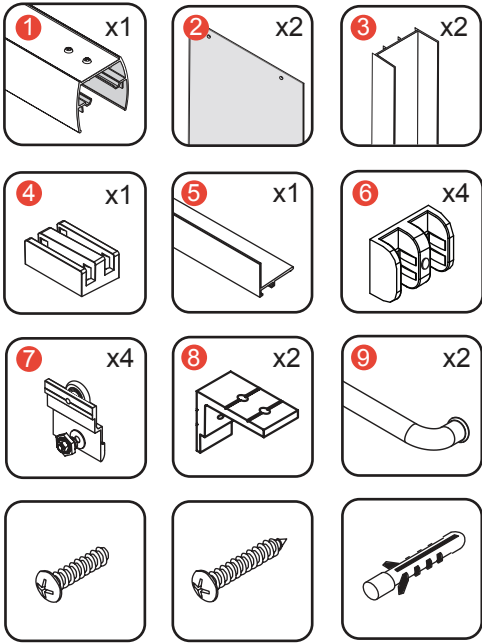

TOOLS NEEDED

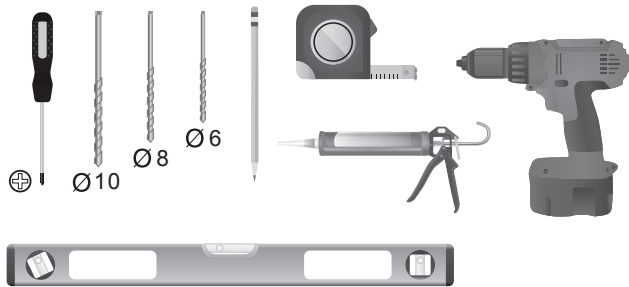

Step 1

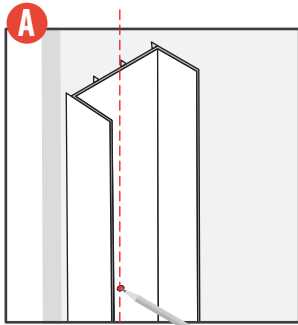

A.1
Level side rail and
mark holes

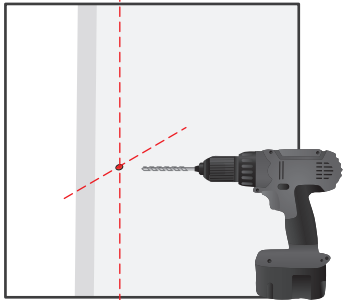

A.2
Drill holes

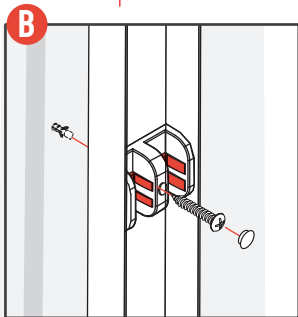

B.1
Mount panel guide
accordingly using
the included
blockers that fit your
glass thickness

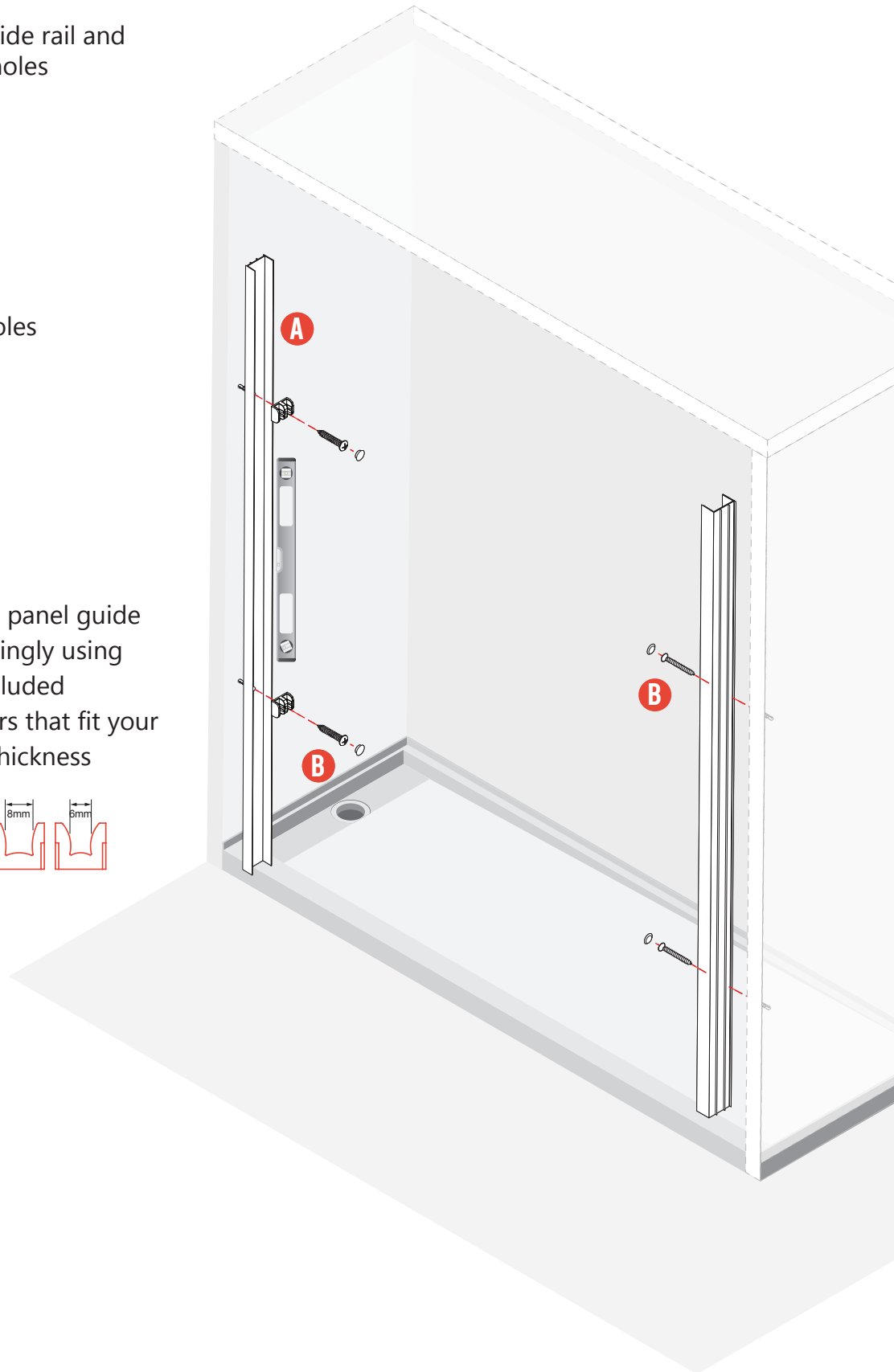
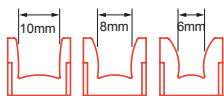

Step 2

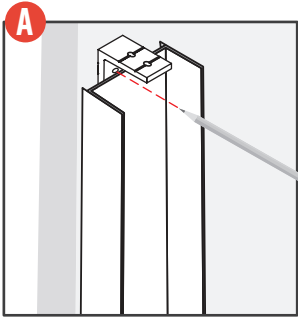

A.1
Position and mark
bracket to mount
top track

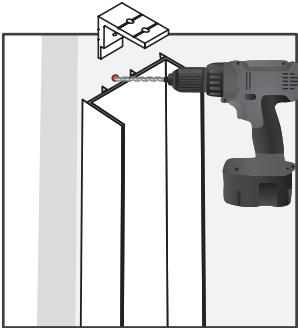

A.2
Drill holes

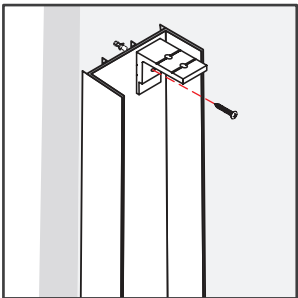

A.3
Mount brackets with
included hardware

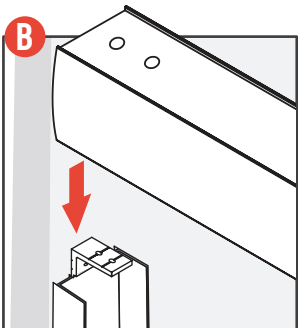

B.1
Position top track
onto brackets

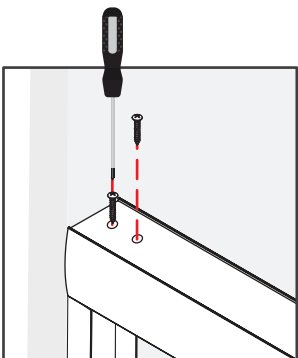

B.2
Use included
hardware to mount
top track to brackets

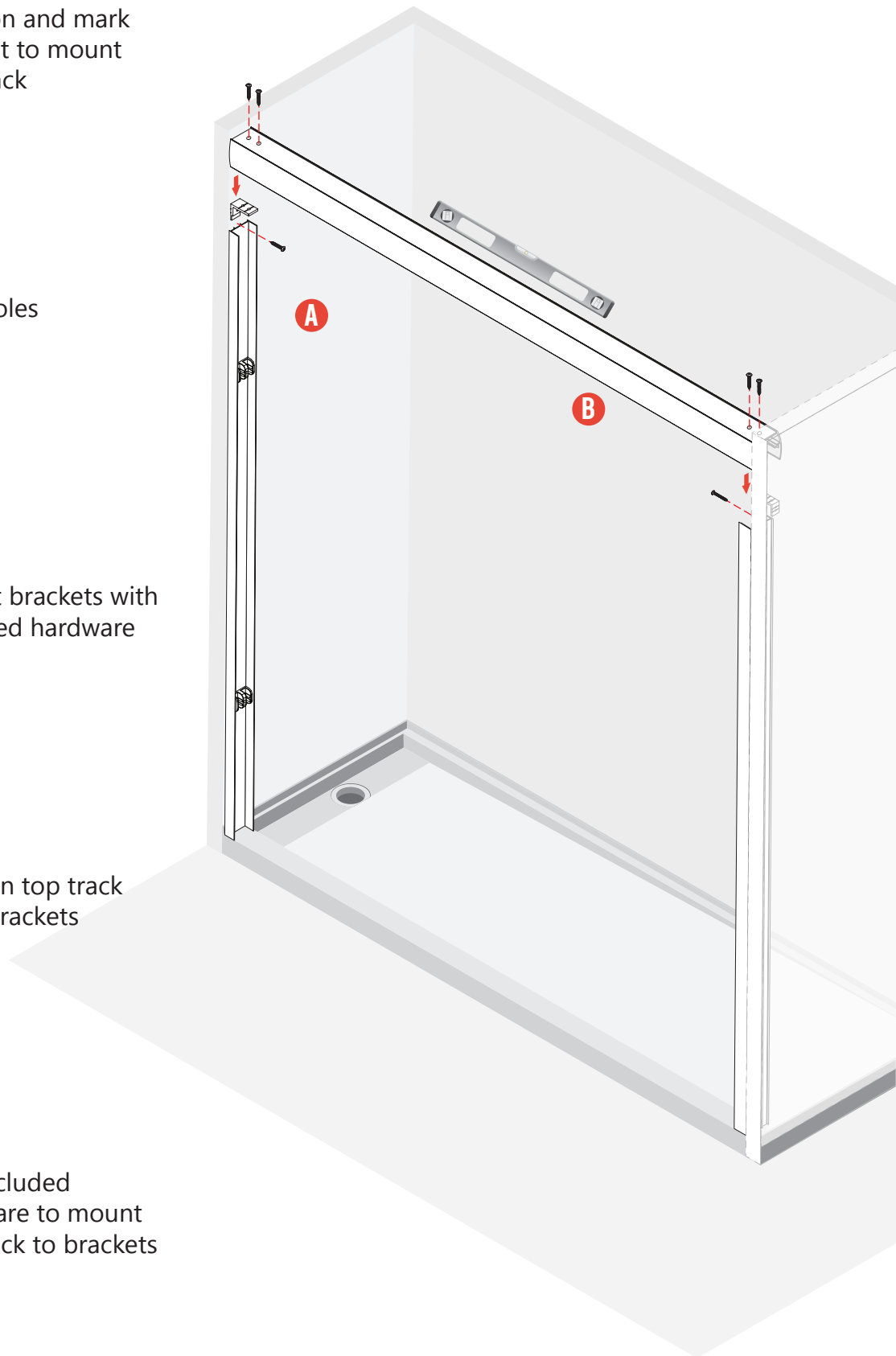

Step 3

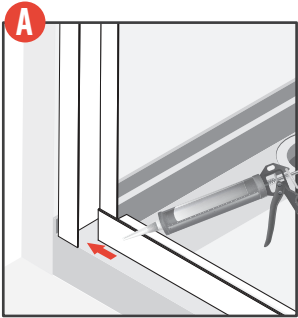

A.1

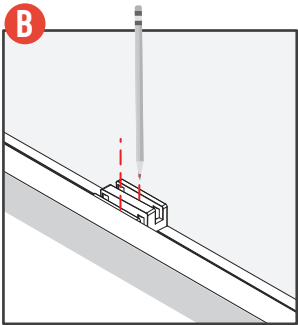

B.1
Position and mark to mount panel guide

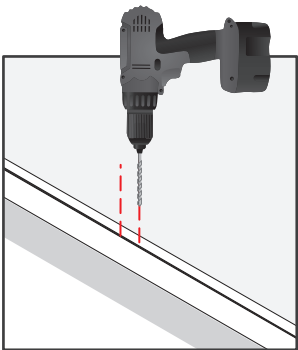

B.2
Drill holes through the sill plate only, not into the shower curb.

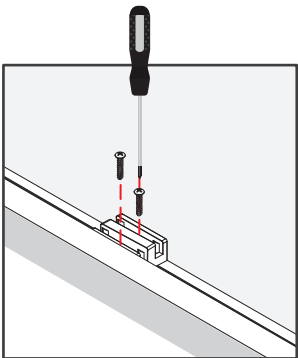

B.3
Use included hardware to mount panel guide
Use the included blockers that fit your glass thickness and placement in floor guide

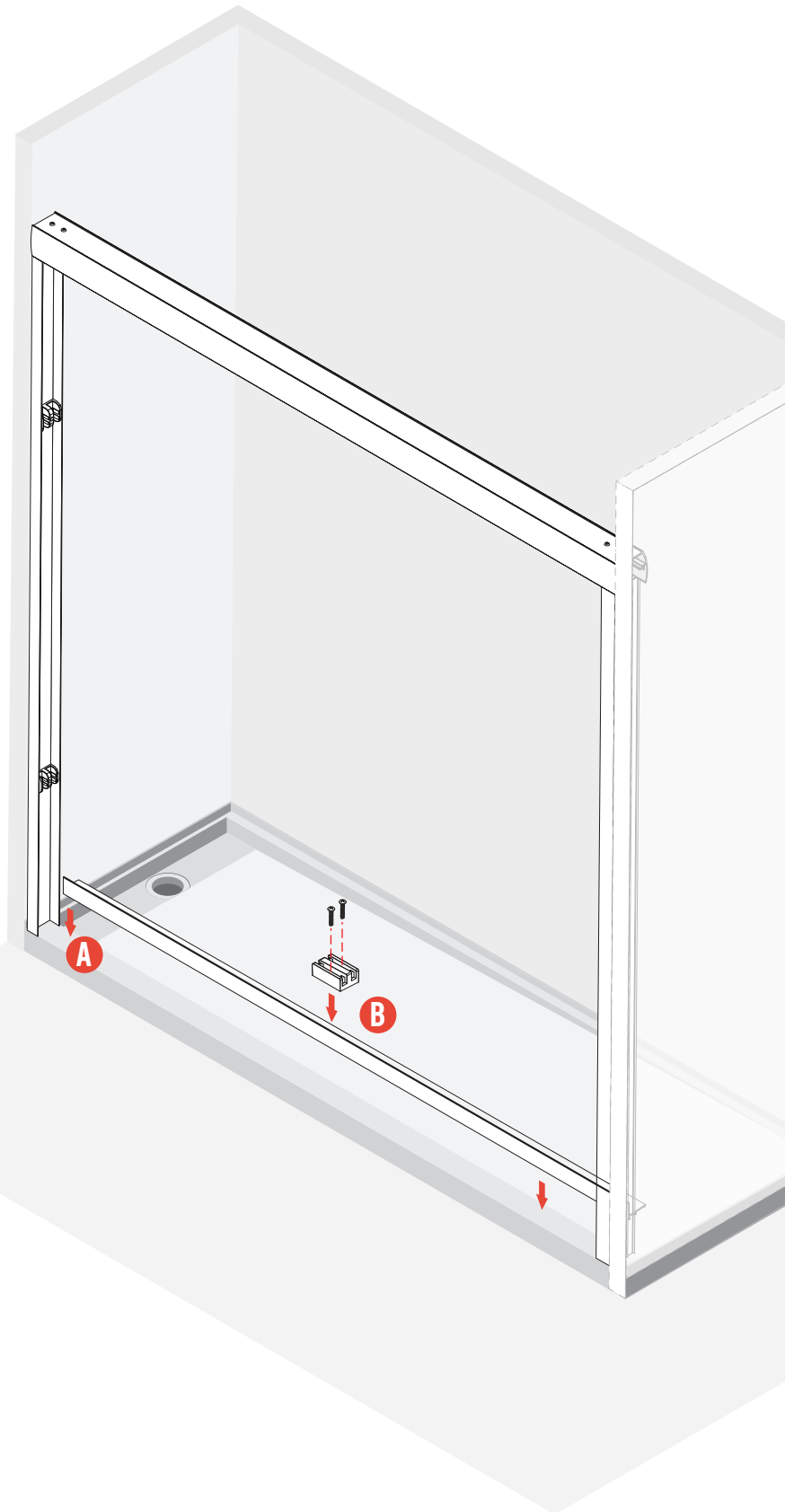
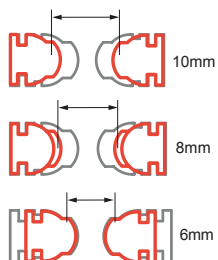

Step 4

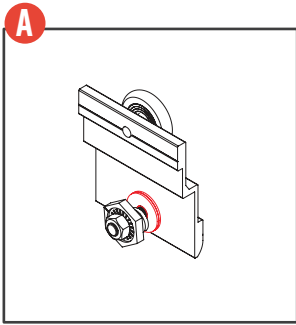

A.1
Select the number of gaskets according to the glass thickness

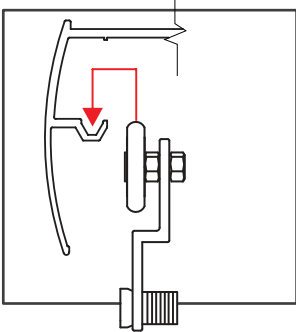

A.2
Insert rollers on to rails as pictured before attaching to glass doors.

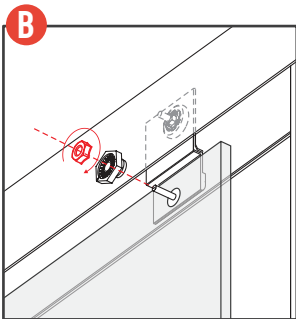

B.1
Mount glass doors to hangers and tighten bolts

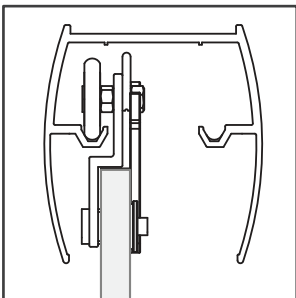

B.2

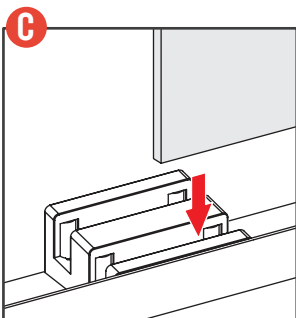

C.1
Glass panel should glide smoothly through bottom panel guide and should have a minimum of 1/4" clearance above the sill

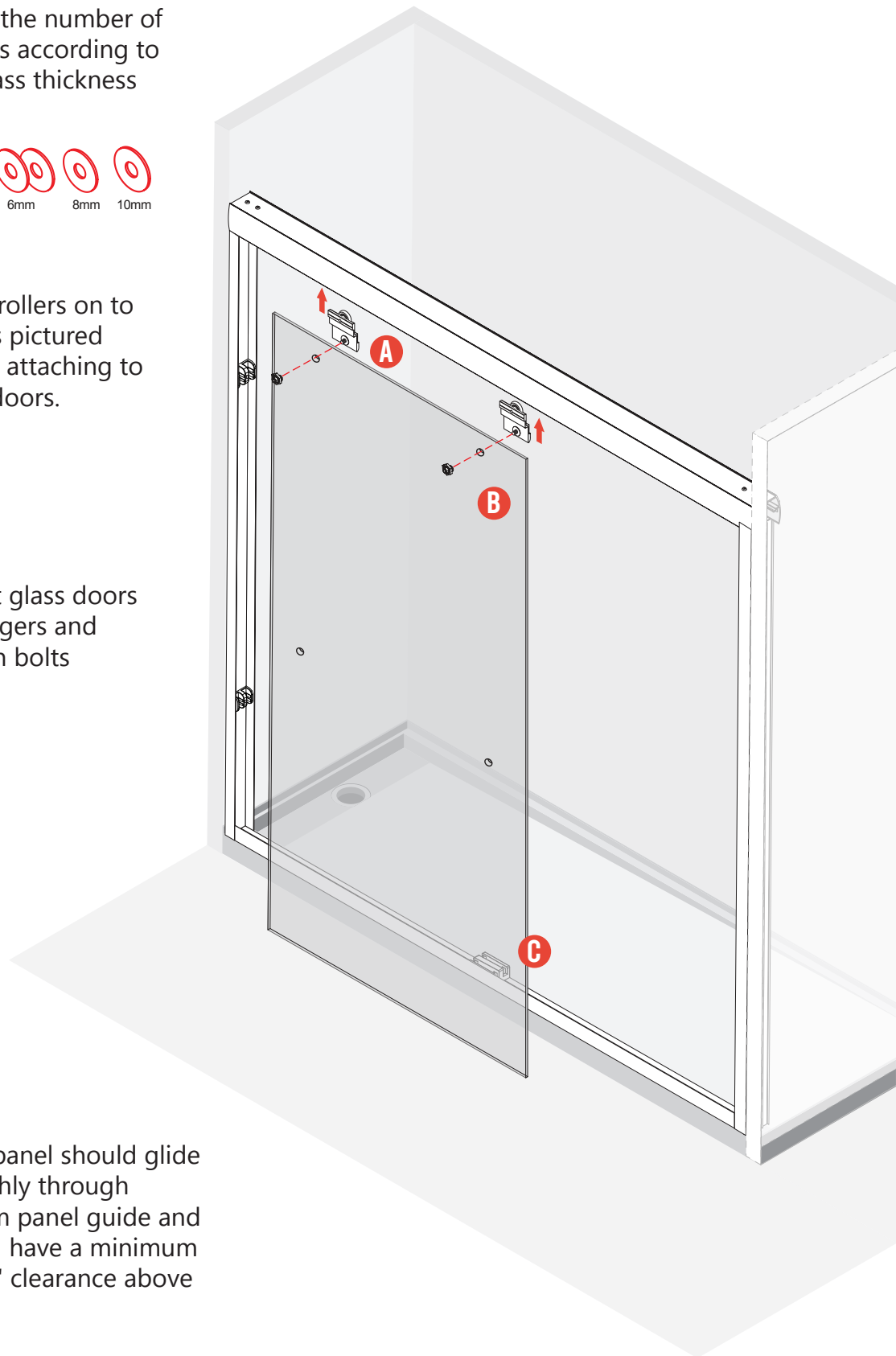

Step 4

C.2

Same steps for installing the second door

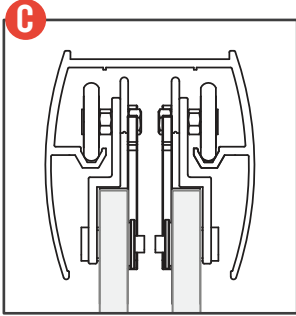

C.3

Make sure both doors slide gently through panel guide

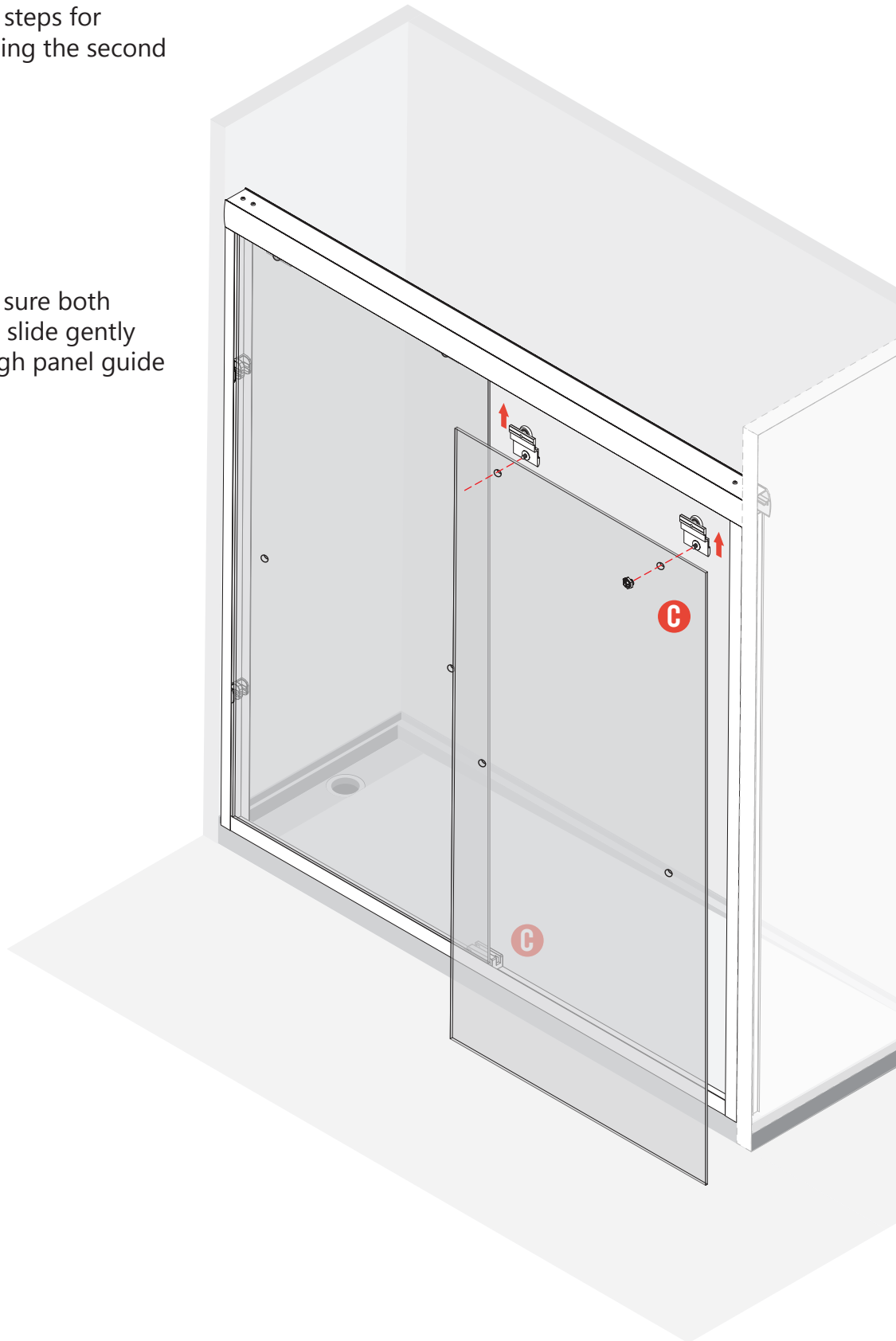
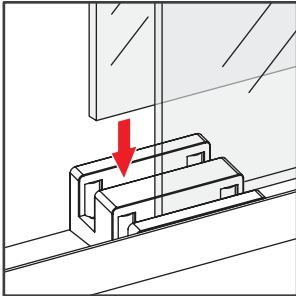

Step 5

A.1
Mount towel bars

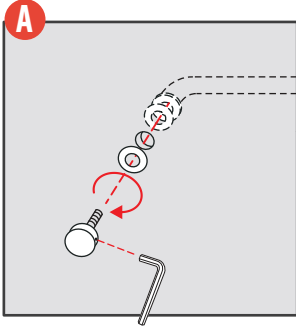

B.1
Caulk the shower framing and sill Inside and Out where they meet the substrates with 100% silicone. Allow to dry 24 hours before the shower is used

