

Architectural Concepts

SONOMA

Framed By Pass Shower Enclosure Installation Instructions

76" OA Height
Fits Standard Opening Range of 54" - 60"
Customization Options Available

The Sonoma shower is a sleek, low-profile frameless bypass shower utilizing 1/4" (6mm) tempered glass. A square towel bar is affixed to the exterior panel for convenience, and a circular flush pull on the interior panel to maximize functionality with minimized hardware presence.

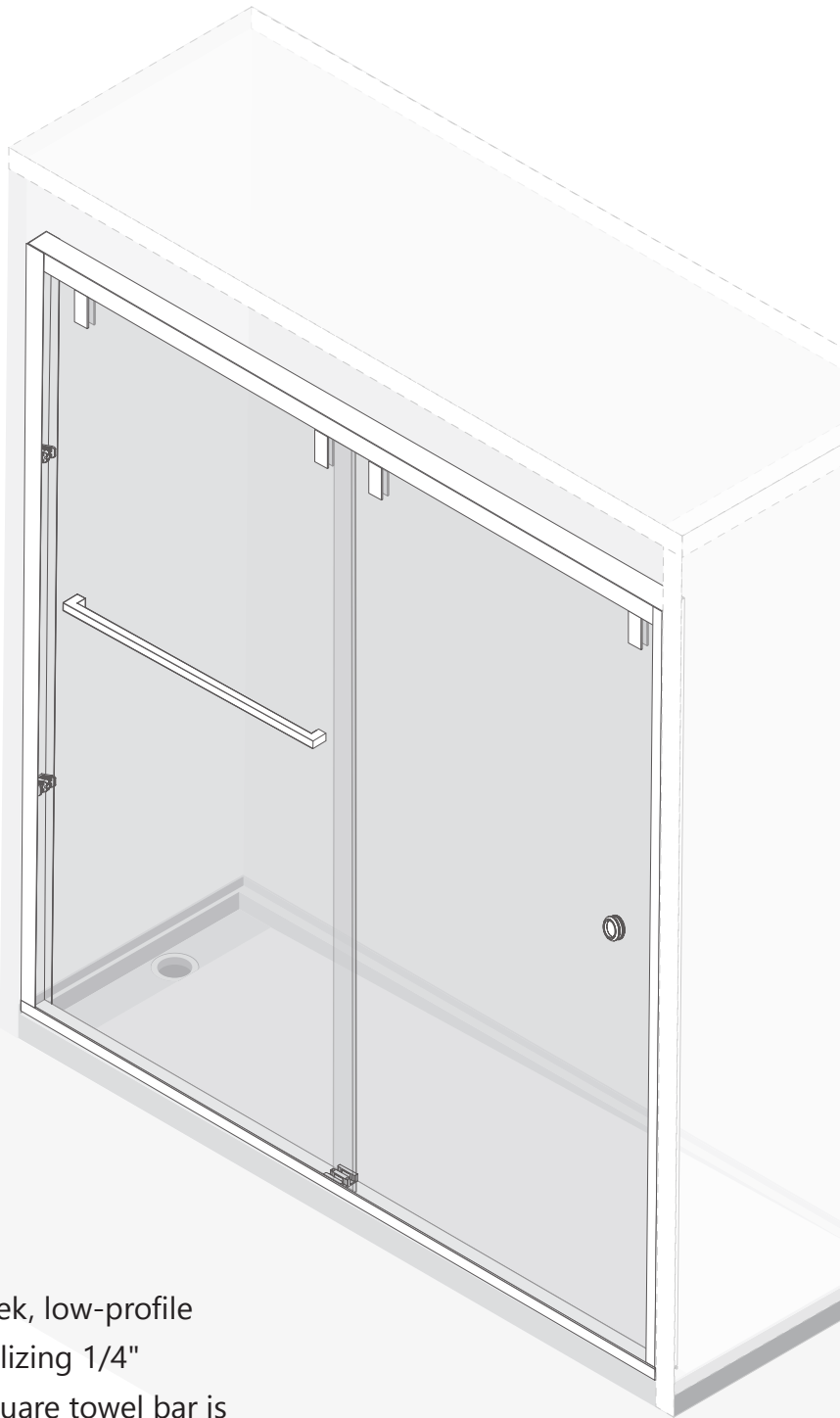

HARDWARE INCLUDED

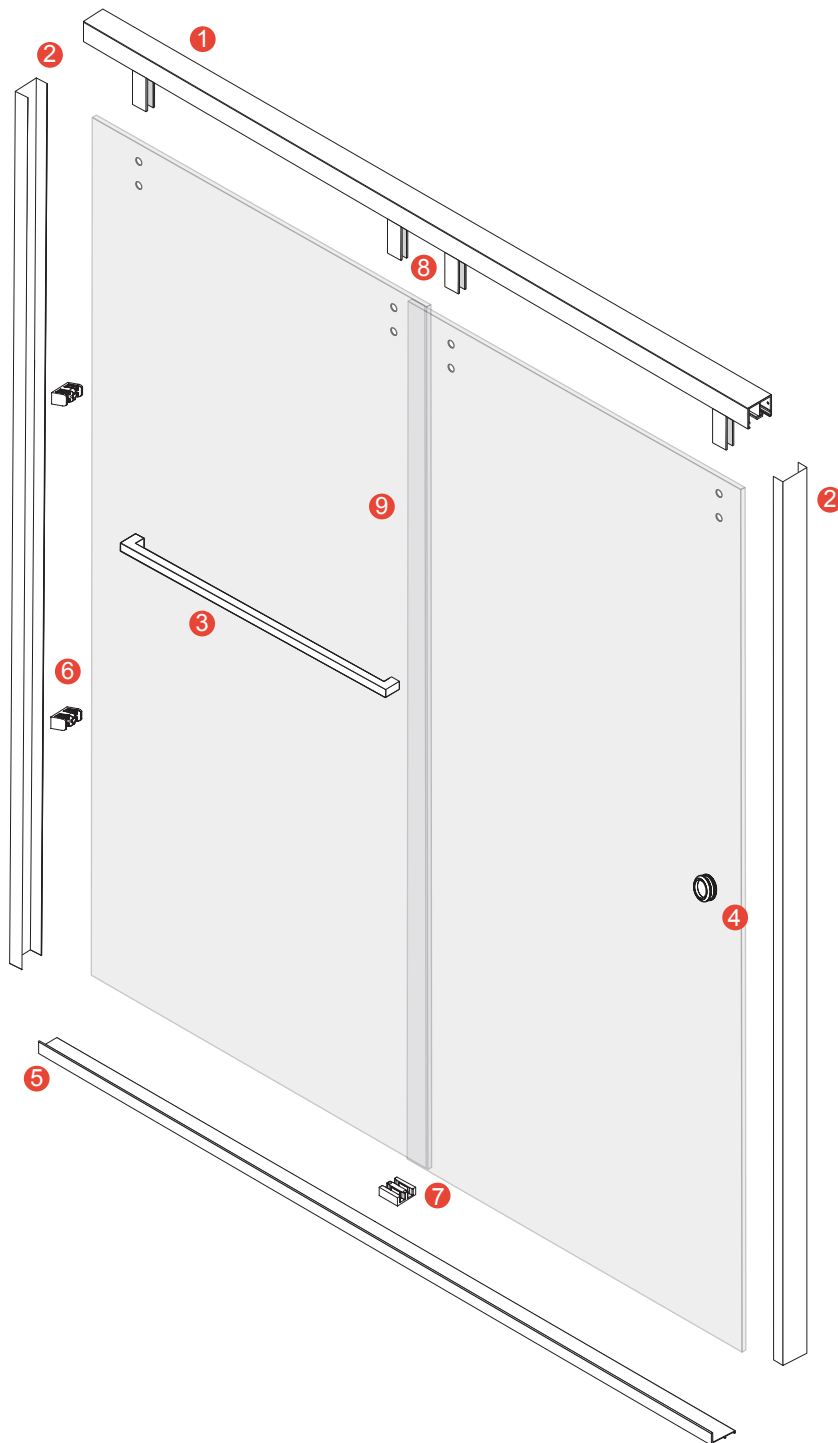
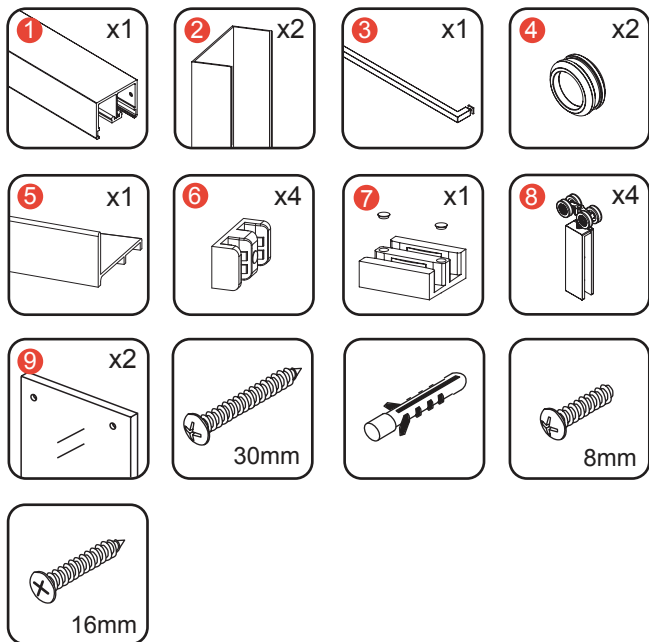

TOOLS NEEDED

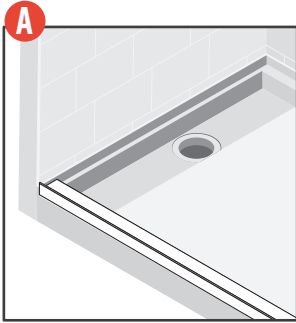

Step 1**A.1**

Position Bottom Rail on shower base. Trim if needed. (Setting rail in a silicone bed can aid in preventing water penetration)

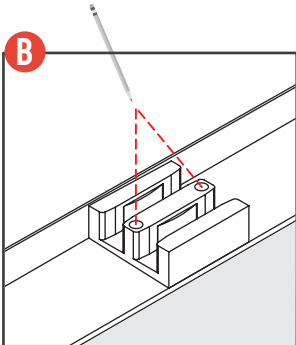
**B.1**

Mark holes to drill, with guide centered with the opening width

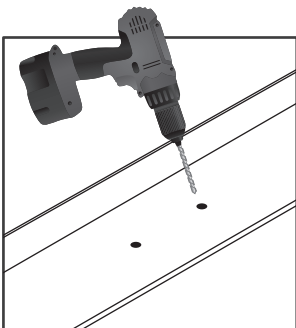
**B.2**

Drill holes through the sill plate only, not into the shower curb.

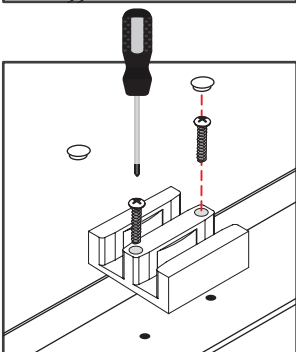
**B.3**

Mount Panel Guide to Bottom Rail with 4x8mm included hardware.

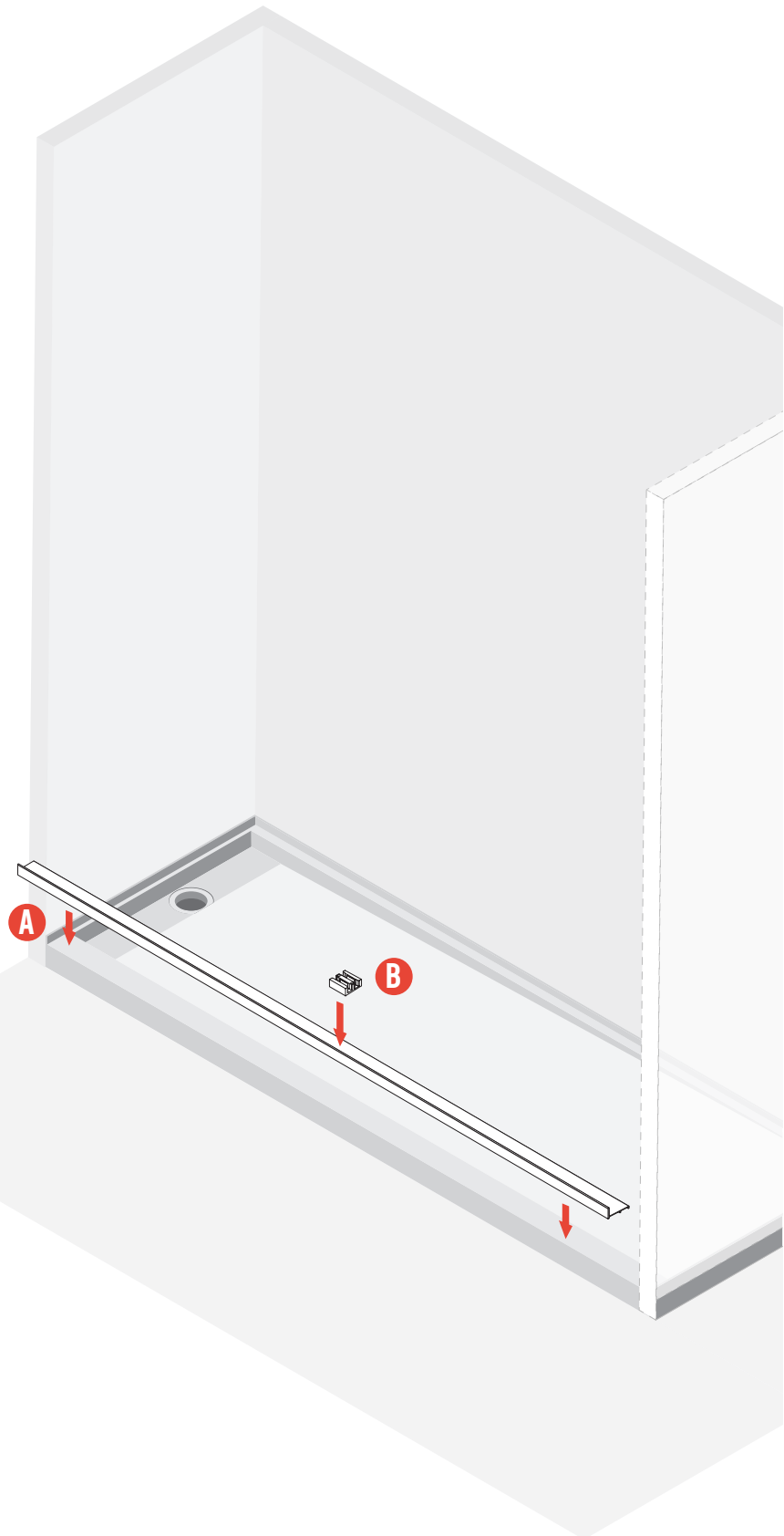

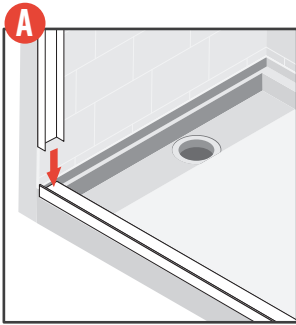
Step 2

A.1
Position Side Rails on Bottom Rail and mount against the wall.

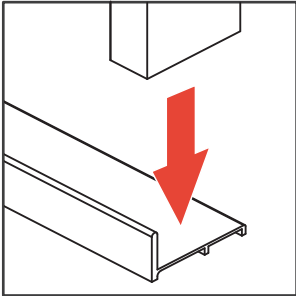

A.2

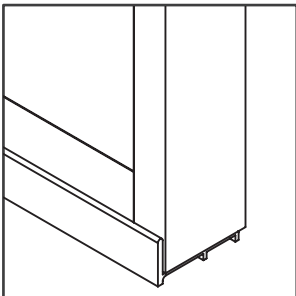

A.3

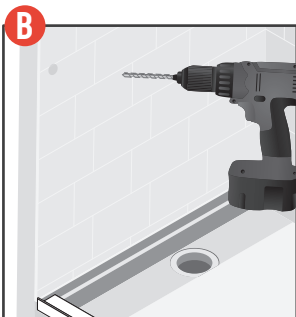

B.1
Mark and drill holes, with guide centered with the opening width

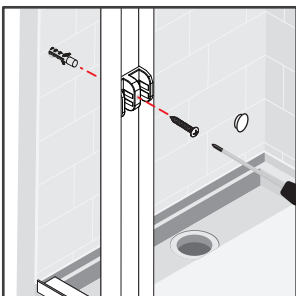

B.2
Use included 4x30mm for attaching the vertical jambs to the wall, using the plastic anchors if required

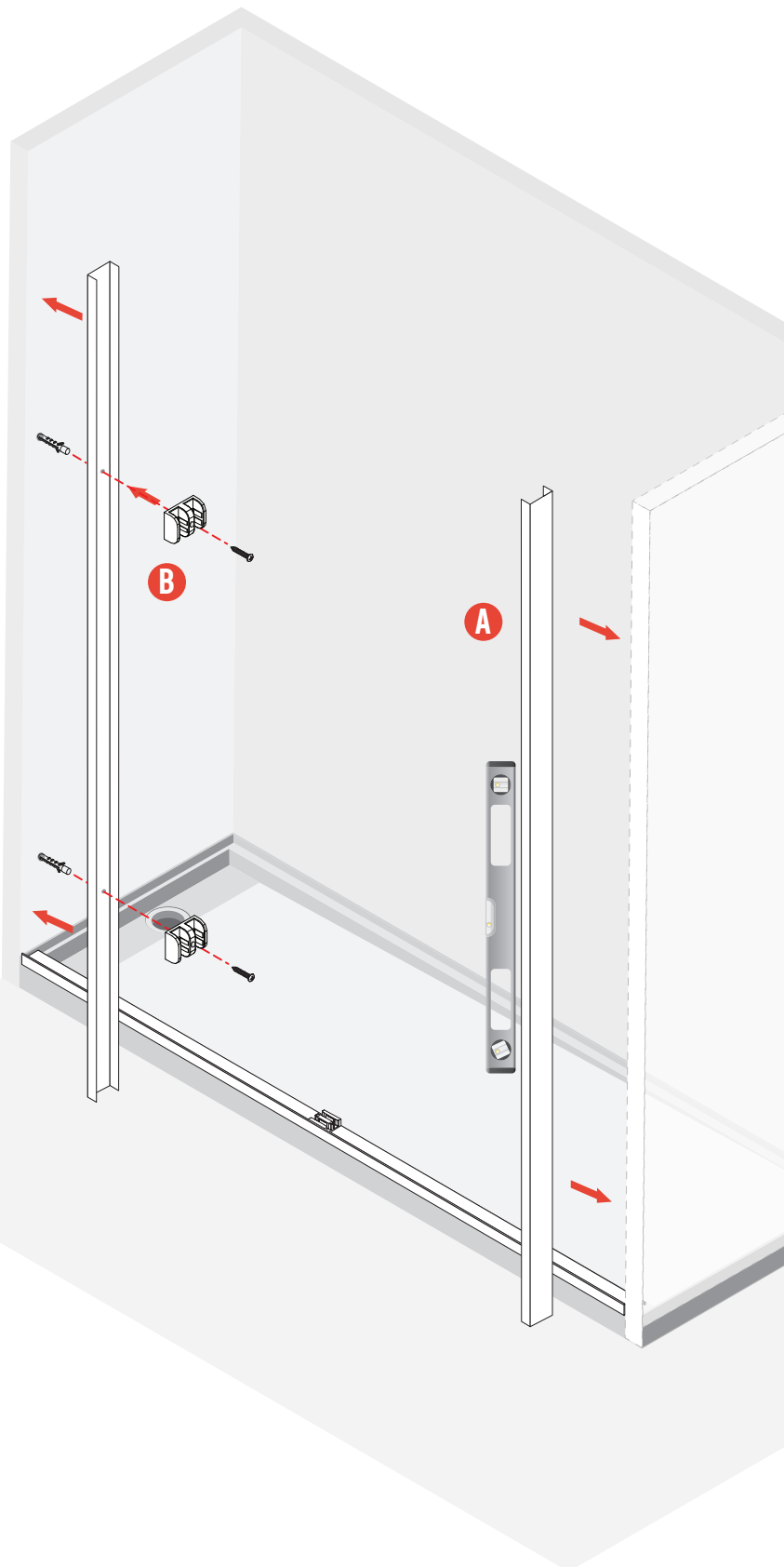

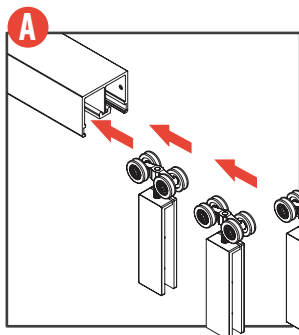
Step 3

A.1
Slide the 4 glass track mounts into the top mounting bracket.

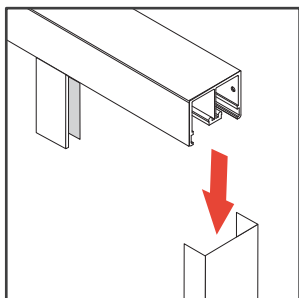

A.2
Position top rail onto side rails and confirm level. Make sure screw holes are on the inside facing shower back wall

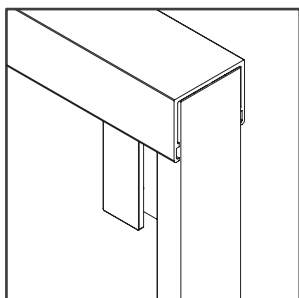

A.3

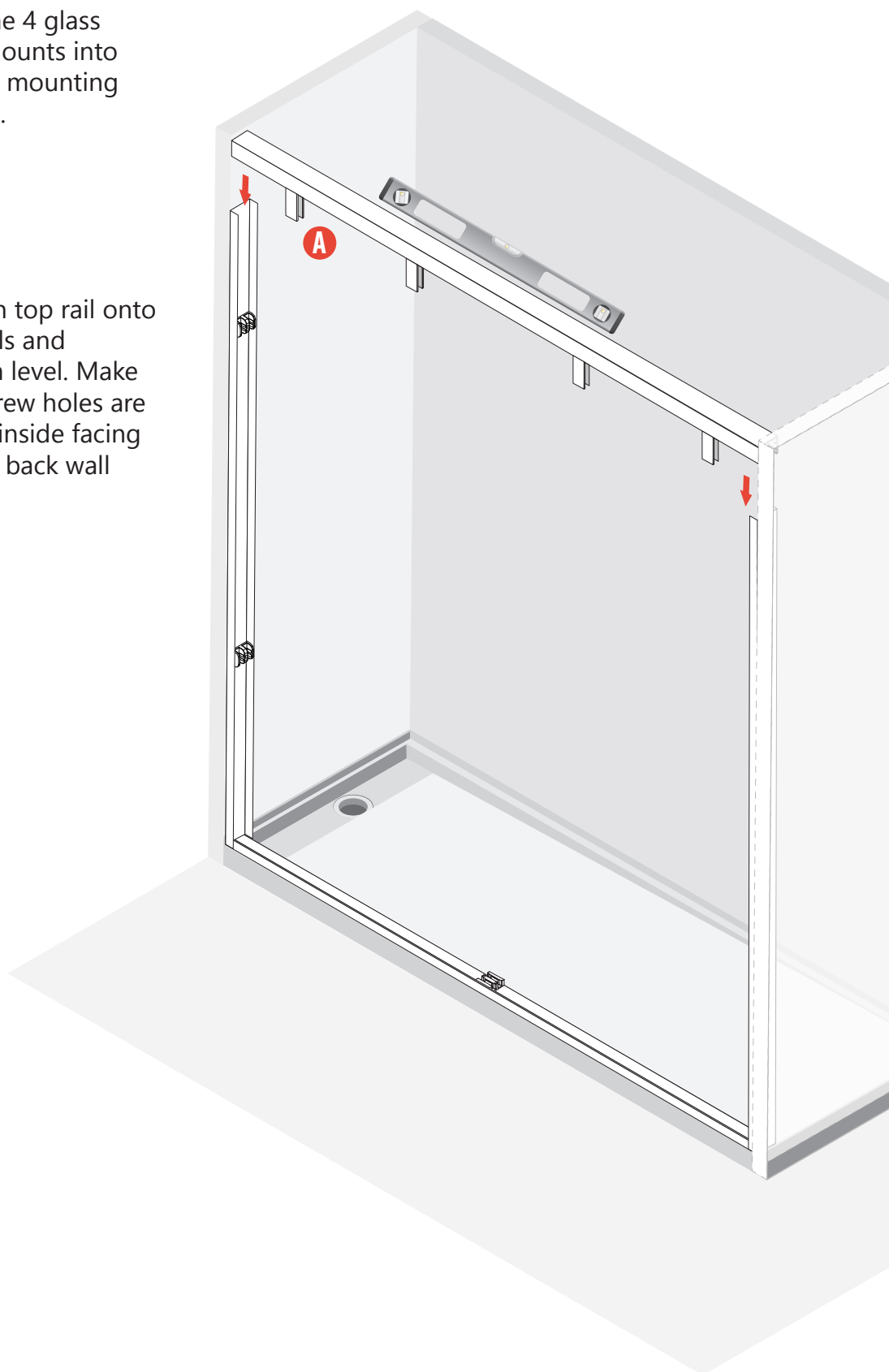

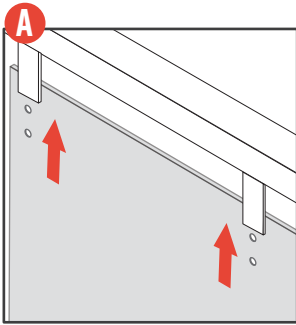
Step 4

A.1
Align brackets with glass

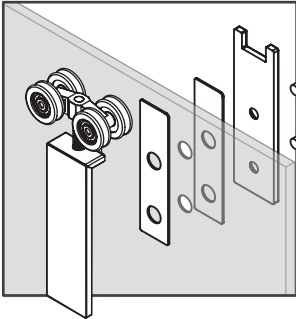

A.2
Mount brackets to glass doors with one gasket positioned on each side of the glass

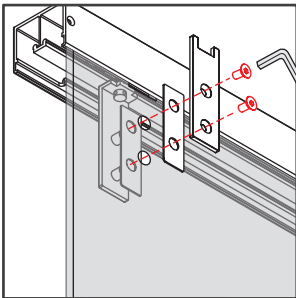

A.3
Tighten screws

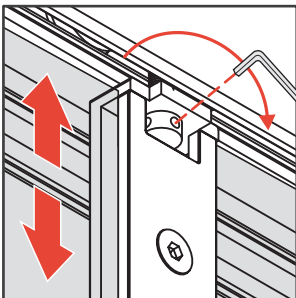

A.4
Use allen wrench to adjust and level glass

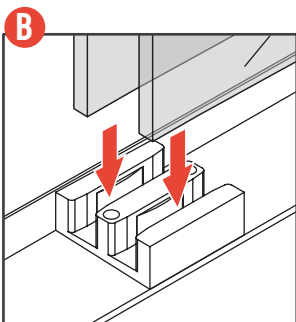

B.1
Glass panels should glide smoothly through bottom panel guide and should have a minimum of 1/4" clearance above the sill

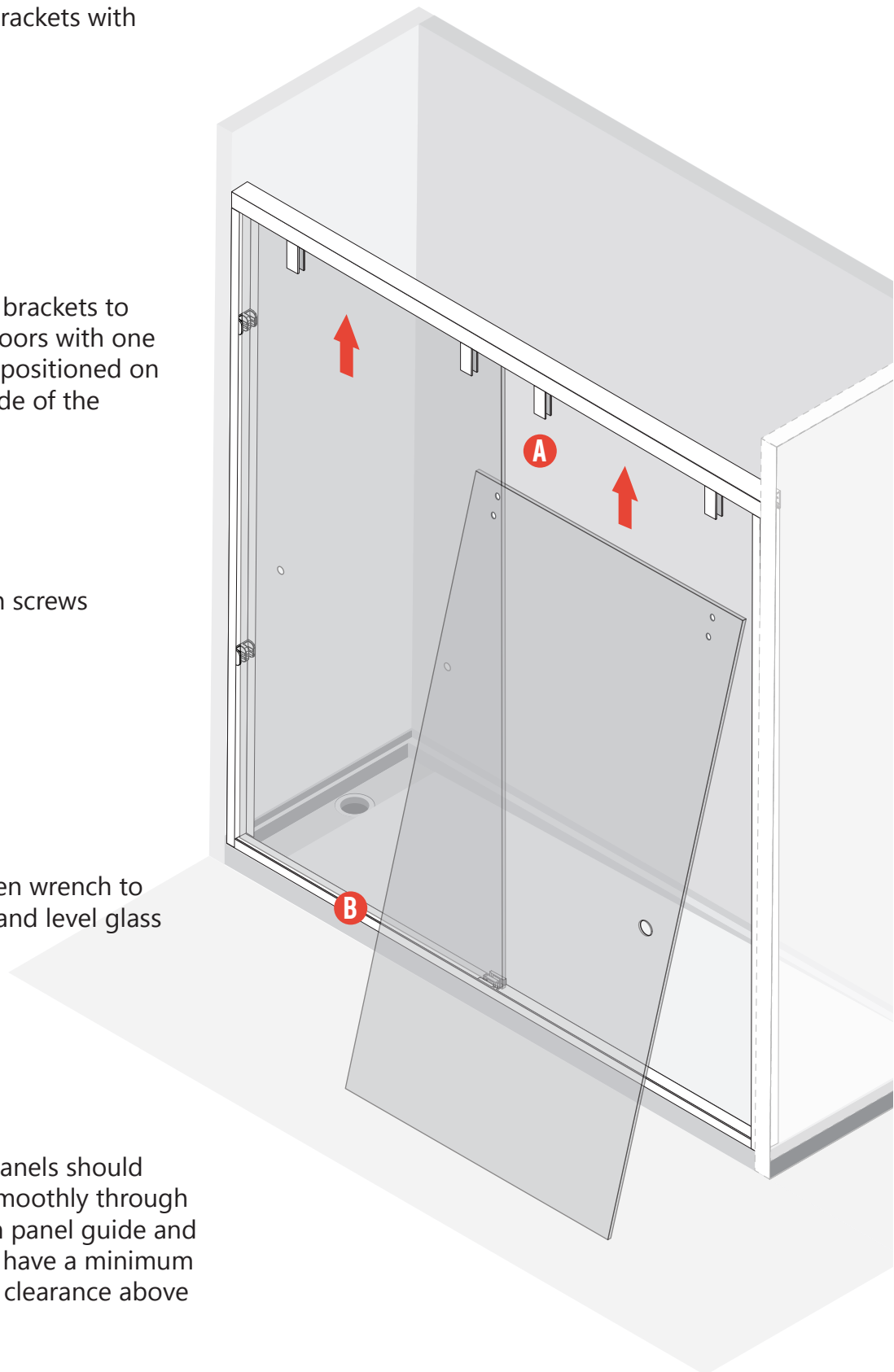

Step 4**C.1**

Use the 4x16mm screws for attaching the header to the vertical jambs, which should be done inside the shower

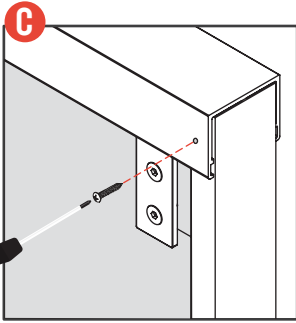
**D.1**

Caulk the shower framing and sill Inside and Out where they meet the substrates with 100% silicone. Allow to dry 24 hours before the shower is used

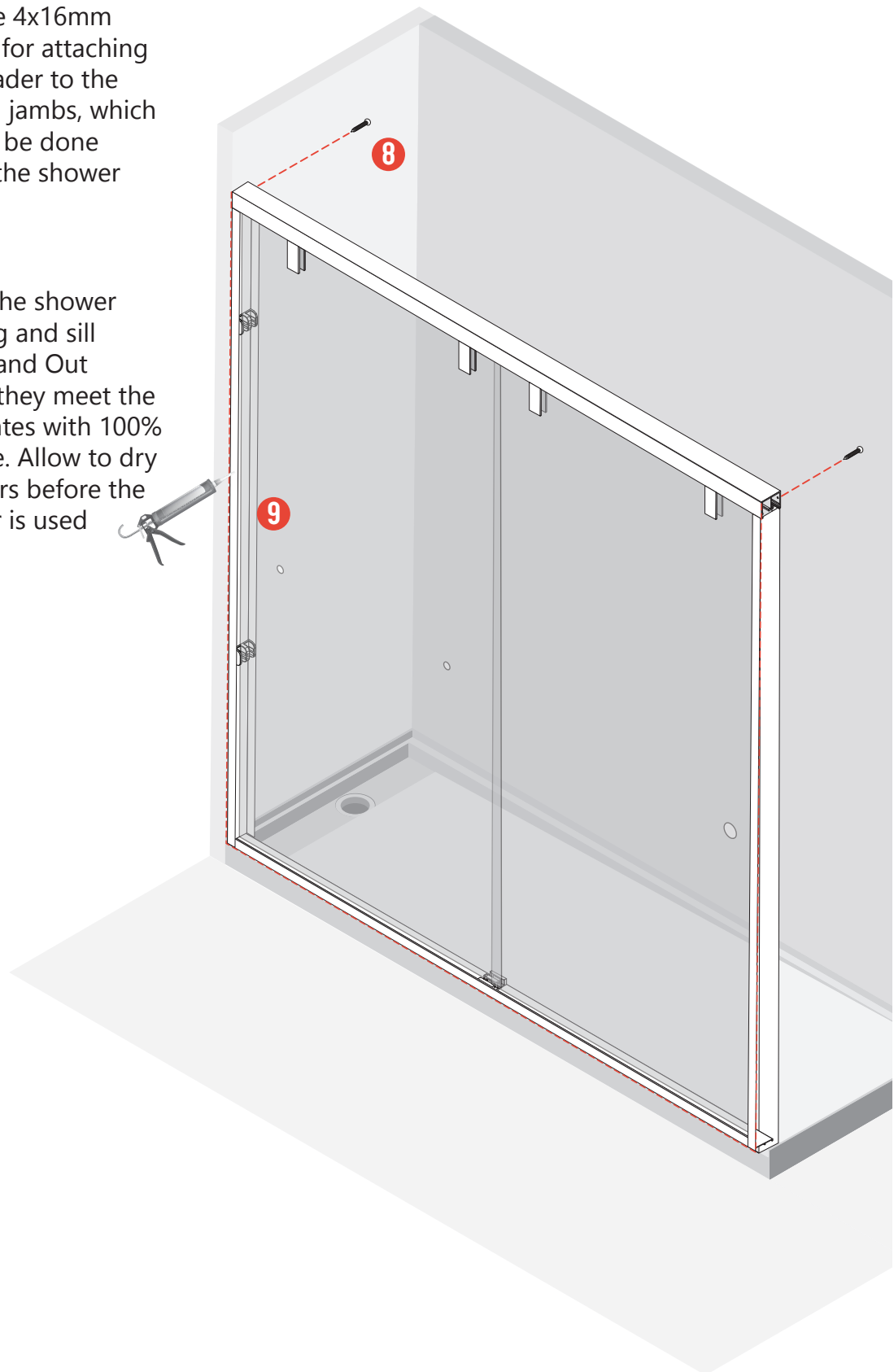
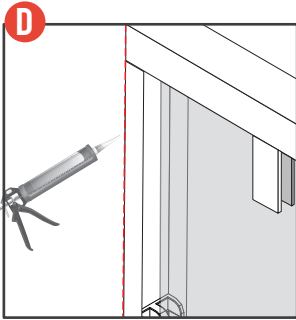

Step 5

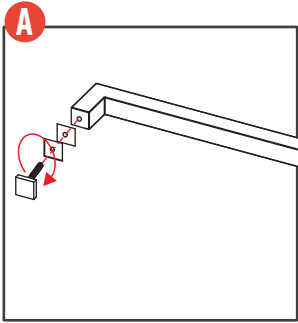

A.1
Mount towel bar

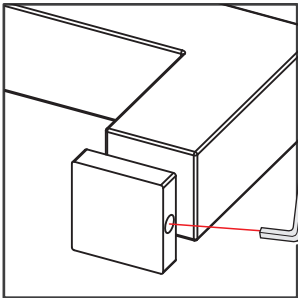

A.2
Tighten with allen wrench

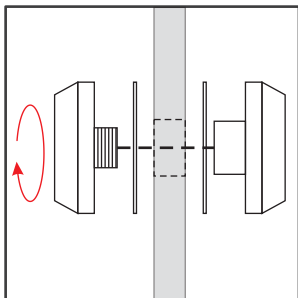

A.3
Mount flush pull

